



Zástupce pro Českou republiku

Telefon: 415 670315

info@falconczech.cz

FALCON CZECH s.r.o.

Mobil: 603 50 60 77

www.falconczech.cz

Osvoboditelů 2649

440 01 Louny



FORZA®

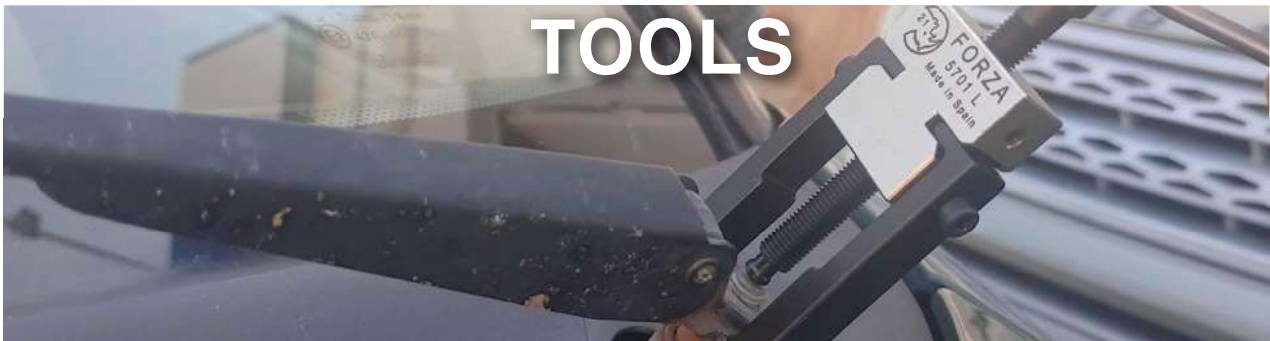
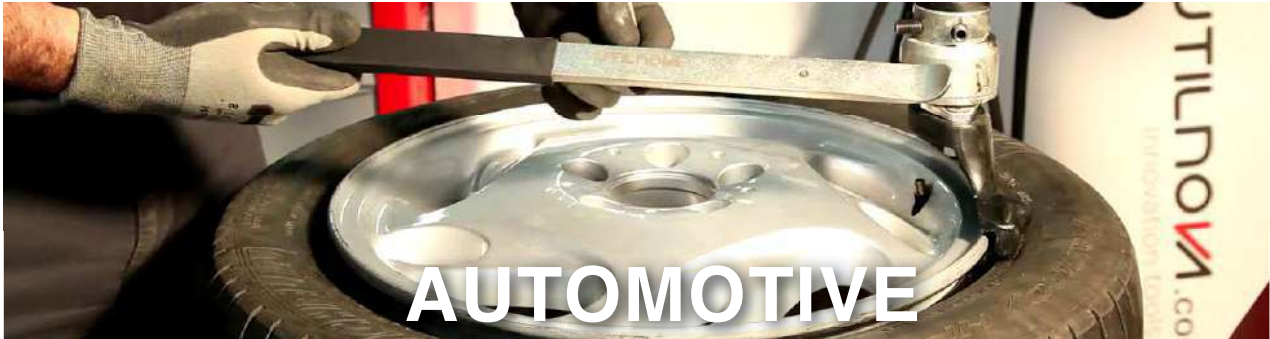

AUTOMOTIVE:

Wide range of tools for vehicle repair and maintenance.

Specialists in filter oil wrenches, injector puller, silent-blocks and ball joint separators.



| | |
|---|---|
|  | Band type oil filter wrench216 |
|  | Oil filter wrenches 217-218 |
|  | Other oil filter wrenches219 |
|  | Direct action ball joint separator220 |
|  | Fork type ball joint separator221 |
|  | Spindle ball joint separator 222-224 |
|  | Other ball joint separators 225 |
|  | Injector pullers 227-231 |
|  | Valve seat cutters 234-237 |
|  | Valve seats remover sets238 |
|  | Silent-Blocks pullers 239-244 |

| | | |
|---|-------------------------------|---------|
|  | Hub puller | 245-248 |
|  | Brake pistons | 249-250 |
|  | Wheel tools..... | 251-252 |
|  | Other wheel tools | 253-254 |
|  | Magnetic plate pullers | 255 |
|  | Pliers battery terminal..... | 256-257 |
|  | Cylinder honing sets | 257 |
|  | Windshield wiper pullers..... | 259 |
|  | Other tools | 260-261 |
|  | Body repair tools | 262-263 |
|  | Diagnostic tools | 264 |

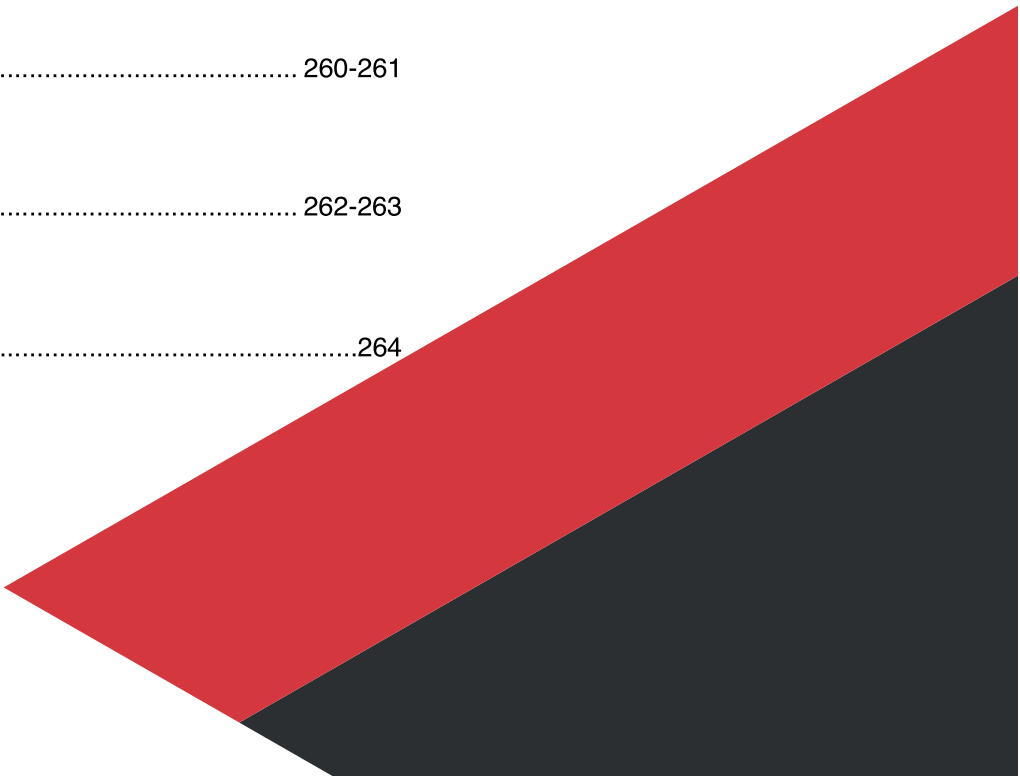

BAND TYPE OIL FILTER WRENCH

50020



Oil filter wrench with a hardened CrVa steel band
Spare bands are available for each model.

Bullet points

- This spanner is very convenient for disassembling and assembling filters in confined spaces.
- Band replacing possibility with a longer one for larger diameters.

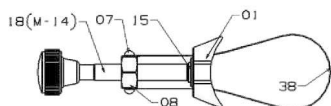

| Ref. | Ømax | Ømin | ⚖️ | Spare parts |
|------|------|------|-----|-------------|
| | | | | Band |
| 5002 | 110 | 65 | 0,5 | 500238 |
| 5003 | 155 | 110 | 0,5 | 500338 |

WATCH VIDEO

SWIVEL HEAD TYPE OIL FILTER WRENCH

T51G



Oil filter wrench with swivel head type.
PVC coated handle.

Bullet points

- This spanner is very convenient for disassembling and assembling filters in confined spaces.



| Ref. | Ømax | Ømin | ⚖️ |
|--------|------|------|-----|
| T51520 | 83 | 73 | 1,9 |
| T51522 | 95 | 87 | 2,6 |
| T51524 | 111 | 101 | 4,6 |

OIL FILTER WRENCH SLIDING TYPE

T51M



Narrow-belt filter wrench
For large filters
Use with 1/2" square drive ratchet



| Ref. | Ø | Type | ⚖️ |
|--------|-----|------|-----|
| T51510 | 300 | Band | 0,4 |

CHAIN TYPE OIL FILTER WRENCH

T51C



Oil filter wrench chain type.
Maximum capacity 108 mm.
For use with 1/2" square drive ratchet, extension bar or 14 mm spark plug spanner.



| Ref. | Ø | Type | ⚖️ |
|--------|-----------|-------|-----|
| 038900 | until 150 | Chain | 0,7 |
| T51501 | 112 | Chain | 0,3 |



OIL FILTER WRENCH WITH ADAPTOR 50000



Puller with high resistance steel jaws including adaptor and valid to work with wrenches, spanners and ratchet.



Bullet points

- It can work either left-hand to release or right-hand to tighten.

| Ref. | B- (Diameter) max | B- (Diameter) min | A-(Jaw height) | Square | ⚖️ | Spare parts |
|-------|-------------------|-------------------|----------------|--------|-----|-------------|
| | | | | | | Adaptor |
| 5000 | 72 | 55 | 31 | 3/8" | 0,4 | 510046 |
| 5001 | 110 | 68 | 37 | 3/8" | 0,8 | 510146 |
| 5001G | 142 | 110 | 55 | 1/2" | 2,3 | 510346 |

OIL FILTER WRENCH TEMPERED JAWS 51000



Puller with high resistance steel jaws. The adaptor for hexagonal head wrench can be purchased separately.



Bullet points

- It can work either left-hand to release or right-hand to tighten.

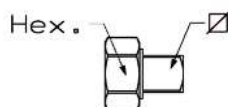

| Ref. | B- (Diameter) max | B- (Diameter) min | A-(Jaw height) | Square | ⚖️ |
|------|-------------------|-------------------|----------------|--------|-----|
| 5100 | 72 | 55 | 31 | 3/8" | 0,3 |
| 5101 | 110 | 68 | 37 | 3/8" | 0,7 |
| 5103 | 142 | 110 | 55 | 1/2" | 2,1 |

MAGNETIC OIL FILTER WRENCH WITH ADAPTOR 5000M0



Puller with high resistance steel jaws including adaptor and valid to work with wrenches, spanners and ratchet.



Bullet points

- It can work either left-hand to release or right-hand to tighten.
- Magnetic for easy filter holding.



| Ref. | B- (Diameter) max | B- (Diameter) min | A-(Jaw height) | Square | ⚖️ | Spare parts |
|--------|-------------------|-------------------|----------------|--------|-----|-------------|
| | | | | | | Adaptor |
| 5000M | 72 | 55 | 31 | 3/8" | 0,4 | 510046 |
| 5001M | 110 | 68 | 37 | 1/2" | 0,8 | 510346 |
| 5001GM | 142 | 110 | 55 | 3/8" | 2,3 | 510146 |



MAGNETIC OIL FILTER WRENCH

5100M0



Puller with high resistance steel jaws
The adaptor for hexagonal head wrench can be purchased separately.



Bullet points

- It can work either left-hand to release or right-hand to tighten.
- Magnetic for easy filter holding

| Ref. | B- (Diameter) max | B- (Diameter) min | A-(Jaw height) | Square | |
|-------|-------------------|-------------------|----------------|--------|-----|
| 5100M | 72 | 55 | 31 | 3/8" | 0,3 |
| 5101M | 110 | 68 | 37 | 3/8" | 0,7 |
| 5103M | 142 | 110 | 55 | 1/2" | 2,2 |

OIL FILTER WRENCH FOR TRUCKS

5000RF



Puller with high resistance steel jaws including adaptor and valid to work with wrenches and 3/8" ratchet. Specially for trucks (Renault and Volvo)



Withstands up to 300Nm of torque.
Fixed non-removable hexagon head

Bullet points

- It can work either left-hand to release or right-hand to tighten

| Ref. | B- (Diameter) max | B- (Diameter) min | A-(Jaw height) | |
|--------|-------------------|-------------------|----------------|-----|
| 5001RF | 110 | 68 | 37 | 0,8 |

ECONOMIC OIL FILTER WRENCH

T51



Puller with metal sheet jaws.



Bullet points

- It can work either left-hand to release or right-hand to tighten

| Ref. | Ømax | Diameter min | Jaw height | |
|--------|------|--------------|------------|-----|
| T51530 | 93 | 62 | 28 | 0,4 |

SQUARE DRIVE ADAPTOR



It adapts the input of the square drive puller to an hexagon socket for conventional wrenches.

| Ref. | Inch | Distance between faces (mm) | |
|--------|------|-----------------------------|-----|
| 510046 | 3/8" | 20 | 0,1 |
| 510146 | 3/8" | 24 | 0,1 |
| 510346 | 1/2" | 30 | 0,2 |



OIL FILTER PLIER

T51870



Oil filters adjustable plier.
For use at heavy vehicles such as tractors.

Bullet points

- Extra long handle for less effort



| Ref. | Ømax | Ømin | |
|--------|------|------|-----|
| T51870 | 89 | 45 | 0,4 |

SOCKETS SET FOR OIL FILTER

T52000



14 oil filter sockets set
High resistance suitcase.

Bullet points

- The socket allows removing the oil filter in confined spaces.



| Ref. | Ømax | Ømin | Square | Reducer | |
|--------|------|------|--------|-------------|-----|
| T52000 | 100 | 65 | 3/8" | 1/2" A 3/8" | 3,1 |

OIL FILTER WRENCH SLIDING TYPE

5940



Oil filter wrench sliding type.
It works with a wrench.
Extensible from Ø63 to 97 mm.



| Ref. | Ø | |
|------|---------|-----|
| 5940 | 63-97mm | 0,4 |



OPEL BALL JOINT SEPARATOR

5071



Suspension direct action ball joint separator.

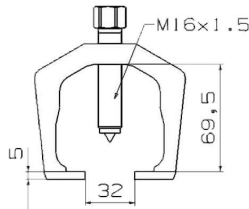

| Ref. | Ball joint diameter | Height | ⚖️ | Spare parts | |
|------|---------------------|--------|-----|-------------|--|
| | | | | Spindle | |
| 5071 | 32 | 69 | 0,8 | 507103 | |

BALL JOINT SEPARATOR DIRECT ACTION

5500



Forged body tempered steel 40 CrMo4.
Tempered steel spindle with fine thread.



Bullet points

- Easy access to ball joints at confined spaces.

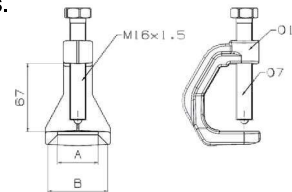

| Ref. | Ball joint diameter | Height | Height | ⚖️ | Spare parts | |
|------|---------------------|--------|--------|-----|-------------|--|
| | | | | | Spindle | |
| 5555 | 36 | 58 | 67 | 0,9 | 569307 | |
| 5557 | 40 | 60 | 67 | 0,9 | 569307 | |
| 5559 | 45 | 62 | 67 | 0,9 | 569307 | |

BALL JOINT SEPARATOR BEAM TYPE

5650



Ball joint separator direct action.

Cast body.

Spindle with steel ball.

Suitable for the dismantling steering columns, shock absorbers, suspensions...



Bullet points

- The push puller beam design makes it able to withstand heavy stresses.

| Ref. | Ball joint diameter | Distance between jaws | Height | ⚖️ | Spare parts | |
|------|---------------------|-----------------------|--------|-----|-------------|--|
| | | | | | Spindle | |
| 5651 | 18 | 40 | 35 | 0,4 | 565103 | |
| 5652 | 25 | 50 | 45 | 0,6 | 565203 | |
| 5653 | 29 | 60 | 55 | 0,9 | 565303 | |
| 5654 | 40 | 80 | 80 | 2,2 | 565403 | |
| 5655 | 58 | 80 | 80 | 2,1 | 565403 | |
| 5656 | 46 | 90 | 100 | 2,3 | 565603 | |

WATCH VIDEO



LIGHT BALL JOINT SEPARATOR

660360



Ball joint separator direct action.
Suitable for most popular car applications.



| Ref. | Ball joint diameter | Height |  |
|--------|---------------------|--------|---|
| 660310 | 19-20 | 50 | 0,4 |

BALL JOINT SEPARATOR LEVEL PROFESSIONAL FORK TYPE



Impact ball joint separator.
Suitable for the dismantling steering columns, shock absorbers, suspensions...



Bullet points

- Its fork-like design allows to be used at confined spaces.

| Ref. | Ball joint diameter | Lenght |  |
|------|---------------------|--------|---|
| 5161 | 18 | 330 | 0,9 |
| 5162 | 23 | 330 | 0,9 |
| 5163 | 31,5 | 330 | 1,1 |
| 5164 | 35 | 350 | 1,3 |

LIGTH BALL JOINT SEPARATOR FORK TYPE

660490



Ball joint separator fork type.
Suitable for the dismantling steering columns, shock absorbers, suspensions...
Fork depth 70mm.

Bullet points

- Its fork-like design allows to be used at confined spaces.

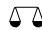
| Ref. | Ball joint diameter | Lenght |  |
|--------|---------------------|--------|---|
| 080600 | 19 | 420 | 1,1 |
| 660490 | 19 | 195 | 0,7 |

4 POSITIONS BALL JOINT SEPARATOR

56730

Ball joint separator 4 positions, lever type.

Bullet points

- Its four holes allow to work in four different height positions.

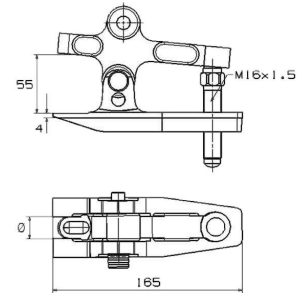

| Ref. | Ball joint diameter | Height |  | Spare parts | |
|--------------|---------------------|--------|--|-------------|--|
| | | | | Spare pin | |
| 5673 | 19 | 55 | 1,9 | 567340 | |
| 5673C | 30 | 55 | 1,9 | 567340 | |

UNIVERSAL BALL JOINT SEPARATOR 5680

5680

Universal ball joint separator lever type.

Bullet points

- Lowered cross head puller for working in very small spaces.
- Central spindle for height adjustment.

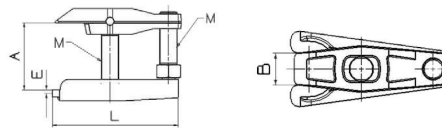

| Ref. | Height | Ball joint max. diameter | Ball joint max. diameter |  | Spare parts |
|-------------|--------|--------------------------|--------------------------|---|-------------|
| | | | | | Spare pin |
| 5680 | 50 | 22 | 18 | 0,8 | 568340 |

UNIVERSAL BALL JOINT SEPARATOR

56810

Universal ball joint separator lever type.

Bullet points

- Central spindle for height adjustment.

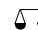

| Ref. | A (Useful height) | Ball joint max. diameter | Ball joint max. diameter |  | Spare parts |
|-------------|-------------------|--------------------------|--------------------------|---|-------------|
| | | | | | Spare pin |
| 5681 | 50 | 22 | 18 | 0,8 | 568340 |
| 5683 | 95 | 32 | 28 | 2,6 | 568340 |
| 5685 | 120 | 36 | 32 | 5,2 | 14X55 |



UNIVERSAL BALL JOINT SEPARATOR 5686 **5686**



Universal ball joint separator lever type.

Bullet points

- Central spindle for height adjustment.
- Less effort is necessary because of the cross head bronze nut.
- Tightening is easier due to the position of the screw head.



| Ref. | A (Useful height) | Ball joint max. diameter | Ball joint max. diameter | Scales | Spare parts | |
|------|-------------------|--------------------------|--------------------------|--------|-------------|--|
| | | | | | Spare pin | |
| 5686 | 120 | 36 | 32 | 5,2 | 14X55 | |

2 POSITIONS BALL JOINT SEPARATOR **5690**



Ball joint separator 2 positions, lever type.

Bullet points

- Two holes allow working in two different height positions.

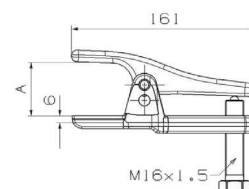

| Ref. | A (Useful height) | Ball joint max. diameter | Ball joint max. diameter | Scales | Spare parts | |
|------|-------------------|--------------------------|--------------------------|--------|-------------|--|
| | | | | | Spare pin | |
| 5691 | 56 | 24 | 20 | 1,2 | 569140 | |

BALL JOINT SEPARATOR 4 POSITIONS WITH EXTENSION **5693**



Ball joint separator 2 positions with extender, lever type.

Bullet points

- Thanks to the extension, it can work up to 4 different height positions.



| Ref. | Maximum opening | Ball joint max. diameter | Ball joint max. diameter | Screw resistance | Scales | Spare parts | |
|------|-----------------|--------------------------|--------------------------|------------------|--------|-------------|--|
| | | | | | | Spare pin | |
| 5693 | 90 | 24 | 20 | 100kg/mm2 | 1,6 | 569140 | |



BALL JOINT SEPARATOR LEVEL TYPE

5695



Ball joint separator lever type for trucks.

Bullet points

- Reinforced beam and lever for high stress resistance.



| Ref. | Ø | Height |  | Spare parts | |
|-------------|----|--------|---|-------------|--|
| | | | | Spare pin | |
| 5695 | 36 | 70 | 4,9 | 569540 | |

HYDRAULIC BALL JOINT SEPARATOR LEVER TYPE

5695H



Ball joint separator lever type for trucks.

Bullet points

- It includes two spindles: Hydraulic and Mechanical.

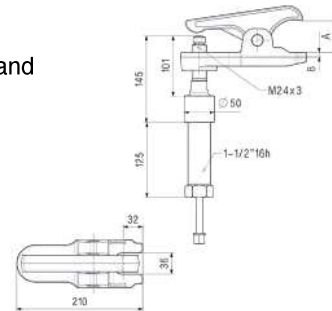

| Ref. | Ø | Height |  | Spare parts | |
|--------------|----|--------|---|-------------|-------------------|
| | | | | Spare pin | Hydraulic spindle |
| 5695H | 35 | 70 | 5,5 | 568140 | 150120 |

MECHANICAL BALL JOINT SEPARATOR FOR TRUCKS

56700



Ball joint separator direct action for heavy cars.

Bullet points

- The internal spindle pin allows hammering during extraction.

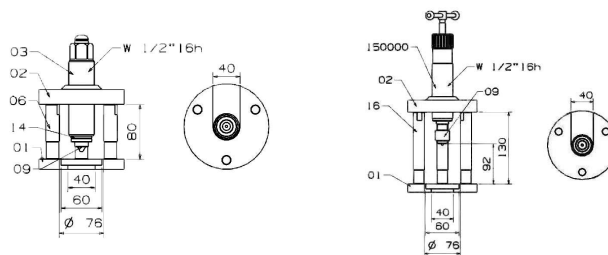

| Ref. | Ømin | Height |  |
|-------------|------|--------|---|
| 5670 | 40 | 80 | 4,6 |
| 5671 | 45 | 92 | 6,5 |



HYDRAULIC BALL JOINT SEPARATOR FOR TRUCKS 5670H0



Ball joint separator direct action for heavy cars.

Bullet points

- Hydraulic spindle for less effort.

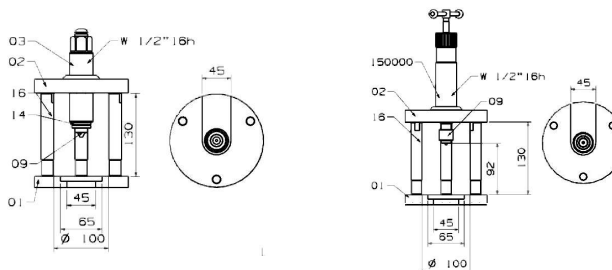

| Ref. | Ømin | Height | ⚖️ | Spare parts |
|-------|------|--------|-----|------------------------------|
| 5670H | 40 | 92 | 5,2 | Hydraulic spindle 150000E |
| 5671H | 45 | 120 | 6,9 | 150000E |

AXIAL BALL JOINT SEPARATOR 5660



Wrench axial ball joint.
Fast and effective.

Bullet points

- It allows the axial ball joint separator replacement without disassembling the rack and pinion.



| Ref. | Internal diameter | ⚖️ |
|------|-------------------|-----|
| 5660 | 41 | 0,4 |



SPINDLES

Complete spindles for silentblock. It includes 2 nuts.



| Ref. | R (Thread) | L (Length) | C (Distance between faces) |  |
|--------|-------------|------------|----------------------------|---|
| 507103 | 5/8"18h | 88 | 19 | 0,1 |
| 565103 | M14 x 1,5 | 60 | 17 | 0,1 |
| 565203 | M16 x 1,5 | 60 | 17 | 0,1 |
| 565303 | M18 x 1,5 | 70 | 19 | 0,2 |
| 565403 | G1/2" x 14h | 110 | 22 | 0,4 |
| 565603 | G3/4" x 14h | 125 | 27 | 0,4 |
| 569307 | M16X1,5 | 110 | 24 | 0,2 |

SPARE PINS

Spare pins for ball joint separator.



| Ref. | Diameter (mm) | Lenght |  |
|--------|---------------|--------|---|
| 567340 | 12 | 65 | 0,1 |
| 568140 | 8 | 32 | 0,1 |
| 568340 | 10 | 45 | 0,1 |
| 569140 | 10 | 60 | 0,1 |
| 569540 | 20 | 65 | 0,2 |
| 14X55 | 14 | 55 | 0,1 |

HYDRAULIC SPINDLE SUPPORT

Ball joint separator adaptor.
It converts the mechanical ball joint separator (5695) into an hydraulic one (5695H).



| Ref. |  |
|--------|---|
| 569515 | 0,7 |



INJECTORS PULLER KIT WITH THREADED ADAPTERS 5150



Injector puller set for removing injectors with slide hammer.
With 5 adapters and 3 spanners for removing injectors without damaging them.
For bosch, Delpi and Siemens injectors...



| Ref. | | Slide hammer | Adapter | Wrench type adapter | Pump pad | Socket adapter with stopped |
|------|-----|--------------|----------------------------|----------------------------|----------|-----------------------------|
| 5150 | 3,1 | 4390 | 515012 515014 515017 | 515022 515023 515028 | 515025 | 515027 |

INJECTORS PULLER KIT WITH SLIDER HAMMER AND PUSH PULLER 5150C



Injector puller set for removing injectors with slide hammer and push puller.
With 5 adapters and 3 spanners for removing injectors without damaging them.
For bosch, Delpi and Siemens injectors...



Bullet points

- The push puller can make more force than the slide hammer.

| Ref. | | Slide hammer | Push puller | Adapter | Wrench type adapter | Pump pad | Socket adapter with stopped |
|-------|-----|--------------|-------------|----------------------------|----------------------------|----------|-----------------------------|
| 5150C | 4,4 | 4390 | 5152 | 515012 515014 515017 | 515022 515023 515028 | 515025 | 515027 |

EXTENDED PULLERS SET 5150 5155



Master set that includes all necessary tools for injectors extractions without damaging them.
Suitable for bosch, Delpi and Siemens.
Ref. 5150 can be extended with adaptors and hexagonal wrenches.

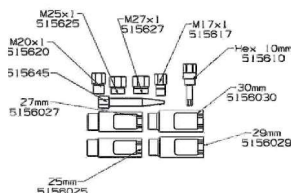

| Ref. | | Adapter | Grooved socket | Hexagonal special wrench |
|------|-----|--|--|--------------------------|
| 5155 | 1,8 | 515617 515620 515625 515627 515645 | 5156025 5156027 5156029 5156030 | 515610 |



UNIVERSAL INJECTOR PULLER

5156



Master set including slide hammer, wrenches and threaded adaptors. Suitable for bosch, Delpi and Siemens. It is supplied in a plastic box.



| Ref. |  | Slide hammer | Adapter | Grooved wrench | Hexagonal special wrench | Socket adapter with stopped |
|------|---|--------------|---------|----------------|--------------------------|-----------------------------|
| 5156 | 7,0 | 4394 | 515014 | 5156025 | 515610 | 515027 |
| | | | 515617 | | | |
| | | | 515620 | | | |
| | | | 515625 | | | |
| | | | 515627 | | | |
| | | | 515645 | | | |

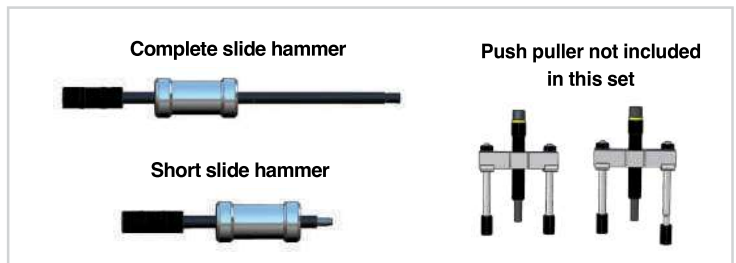
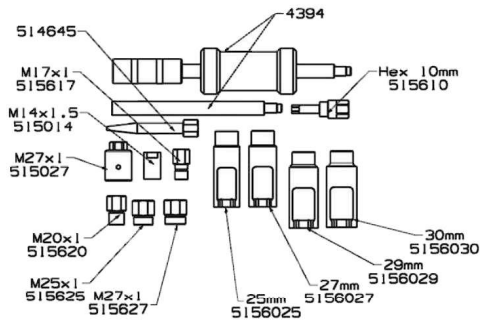



MASTER KIT FOR INJECTORS WITH CLAMPS

5158

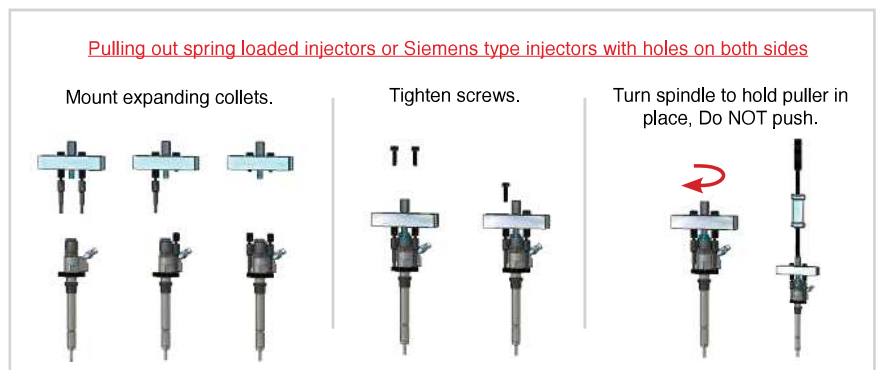

Master set of injector pullers with clamps, 5 adapters and 3 wrenches. For bosch, Delpi and Siemens injectors. Plastic case.



| Ref. |  | Internal collet | Slide hammer | Push puller | Adapter | Wrench type adapter | Pump pad | Tensor + point | Socket adapter with stopped |
|------|---|-----------------|--------------|-------------|---------|----------------------------|----------|----------------|-----------------------------|
| 5158 | 4,8 | 4000 4010 | 4390 | 5152 | 515012 | 515022 515023 515028 | 515025 | 515030 | 515027 |
| | | | | | 515014 | | | | |
| | | | | | 515017 | | | | |



INJECTORS PULLER KIT SERIE 6150 WITH THREADED ADAPTORS 6150



Injector pullers set with slide hammer.
Suitable for bosch, Delpi and Siemens.
Supplied in a plastic box.

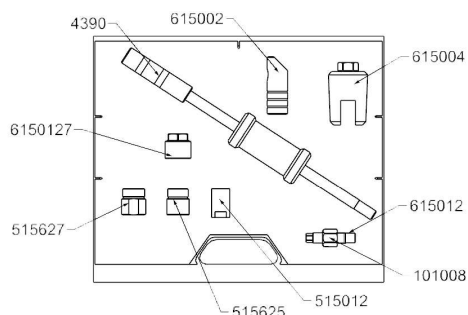

| Ref. | | Slide hammer | Adapter | Socket |
|-------------|-----|--------------|---------|--------|
| 6150 | 3,9 | 4390 | 515012 | 615004 |
| | | | 515625 | |
| | | | 515627 | |
| | | | 615002 | |
| | | | 615012 | |
| | | | 615027 | |

INJECTORS PULLER KIT WITH SLIDER HAMMER AND PUSH PULLER 6150C



Injector pullers set with slide hammer.
Included, whaser injector extractor.
Suitable for bosch, Delpi and Siemens.
Supplied in a plastic box.

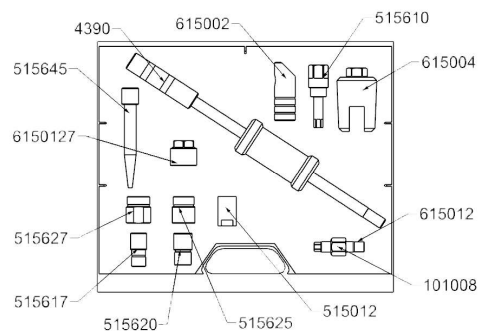

| Ref. | | Slide hammer | Adapter | Hexagonal special wrench | socket |
|--------------|-----|--------------|---------|--------------------------|--------|
| 6150C | 0,3 | 4390 | 515012 | 515610 | 615004 |
| | | | 515625 | | |
| | | | 515627 | | |
| | | | 515645 | | |
| | | | 615002 | | |
| | | | 615012 | | |
| | | | 615027 | | |



PUSH PULLER FOR INJECTORS

51510

Push puller for removing injectors.
The push puller adapts to the cylinders head for a safer extraction.

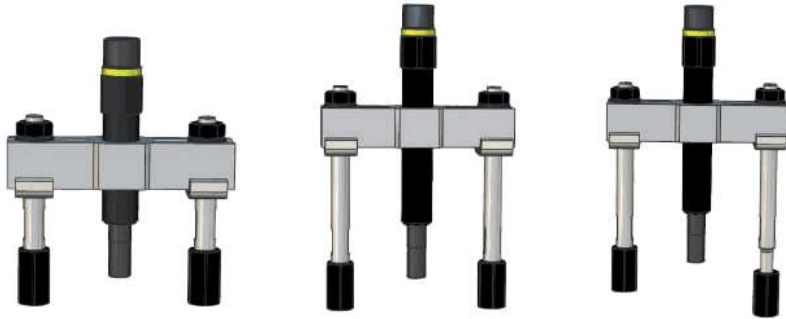

| Ref. | Opening | Height |  |
|------|---------|--------|---|
| 5151 | 110 | 122 | 1,2 |
| 5152 | 110 | 62 | 1,4 |

PULLER FOR INJECTORS INTERNAL COLLETS TYPE

5154

The set consists of a puller and 2 sets of internal collets: One set includes collets of Ø6 to Ø8 and the other one collets of Ø8 to Ø10.
For Volkswagen and Siemens injector pumps.





| Ref. |  | Internal collet |
|------|---|-----------------|
| 5154 | 0,7 | 4000 4010 |

INJECTOR PULLER WITH SLIDE HAMMER

085500

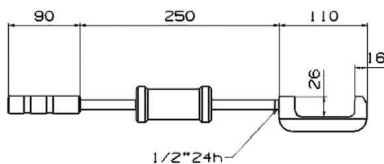
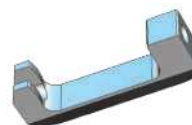
Injector Puller with slide hammer
For CDI type injectors.



| Ref. |  | Slide hammer |
|--------|---|--------------|
| 085500 | 1,7 | 4390 |



UNIVERSAL INJECTOR EXTRACTORS WITH SLIDE HAMMER

H5140



Unique and universal set that allows the removal of moderately seized or rusty injectors without removing the electrical part in the most modern vehicles.

For Common rail or Piezo type injectors for Denso, Siemens bosch and Delpi brands from 1999 to 2017.

The set also includes two adapters, M12 and M14.



Bullet points

- It prevents disassembly of the injector's electrical connection.
- It fits to the threaded side hole of the fuel inlet that it is extremely strong.

| Ref. | Adapters | |
|-------|-----------|-----|
| H5140 | M12 y M14 | 4,5 |

PNEUMATIC INJECTOR PULLER

4382



Pneumatic tool that easily allows to remove seized injectors. It is supplied with set of universal adapters covering Bosch, Delphi, Denso, Siemens CR etc. injectors. Cylinder, hose and 19 adapters included. Covers 90% of injectors.



Bullet points

- The pneumatic cylinder that replaces the slide hammer, facilitates the extraction.
- The vibration of the pneumatic cylinder helps to loosen the injector.



WATCH VIDEO

| Ref. | To | B | | Adaptor | Adapter |
|------|------|--------------------|-----|------------------|-----------------|
| 4382 | Hose | Pneumatic cylinder | 6,7 | 438008 438010 | 438214 - 438213 |
| | | | | | 438212 - 438207 |
| | | | | | 438218 - 438219 |
| | | | | | 438220 - 438215 |
| | | | | | 438216 - 438217 |
| | | | | | 438222 - 438221 |
| | | | | | 438224 - 438225 |
| | | | | | 438226 - 438227 |
| | | | | | 438228 |
| | | | | | 438228 |



SPARE BRUSHES



| Ref. |  |
|---------|---|
| H5130-6 | 0,1 |
| H5130-7 | 0,1 |

ADAPTORS

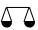

| Ref. | Inlet thread | Outlet thread |  | Ref. | Inlet thread | Outlet thread |  |
|--------|--------------|---------------|---|--------|--------------|---------------|---|
| 515012 | 1/2" 24h | M12 X 1,5 | 0,1 | 438207 | M14 | M8X1 | 0,1 |
| 515014 | 1/2" 24h | M14 X 1,5 | 0,1 | 438218 | M14 | M27X0,75 | 0,1 |
| 515017 | 1/2" 24h | M17 X 0,75 | 0,1 | 438219 | M14 | M25X0,5 | 0,1 |
| 515617 | 1/2" 24h | M17 X 1 | 0,1 | 438220 | M14 | M29X1 | 0,1 |
| 515620 | 1/2" 24h | M20 X 1 | 0,1 | 438215 | M14 | M27x1 | 0,1 |
| 515625 | 1/2" 24h | M25 X 1 | 0,1 | 438216 | M14 | M25X1 | 0,1 |
| 515627 | 1/2" 24h | M27 X 1 | 0,1 | 438217 | M14 | M27X1 | 0,1 |
| 515645 | 1/2" 24h | Como arandela | 0,1 | 438222 | M14 | M14X1,5 | 0,1 |
| 615002 | 1/2" 24h | M12 X 1,75 | 0,1 | 438221 | M14 | M26X0,75 | 0,1 |
| 615012 | 1/2" 24h | M12 X 1,50 | 0,1 | 438224 | M14 | M16x1,5 | 0,1 |
| 615027 | 1/2" 24h | M27 X 1 | 0,1 | 438225 | M14 | M16X1,5 | 0,1 |
| 438214 | M14 | M20X1 | 0,1 | 438226 | M14 | M18X1,5 | 0,1 |
| 438213 | M14 | M18X0,75 | 0,1 | 438227 | M14 | M22X1,5 | 0,1 |
| 438212 | M14 | M17X1 | 0,1 | 438228 | M14 | M20X1,5 | 0,1 |

ADAPTOR WRENCH TYPE



| Ref. | Inlet thread |  |
|--------|--------------|---|
| 515022 | 1/2" 24h | 0,1 |
| 515023 | 1/2" 24h | 0,1 |
| 515028 | 1/2" 24h | 0,1 |

HEXAGONAL GROOVED SOCKET



| Ref. | Hexagon |  |
|---------|---------|---|
| 5156025 | 25mm | 0,1 |
| 5156027 | 27mm | 0,1 |
| 5156029 | 29mm | 0,1 |
| 5156030 | 30mm | 0,1 |



HEXAGONAL SPECIAL WRENCH



| Ref. | Hexagon | |
|--------|---------|-----|
| 515610 | 10mm | 0,1 |

BRAKE PAD



| Ref. | |
|--------|-----|
| 515025 | 0,1 |

SOCKET ADAPTER WITH STOPPER



| Ref. | Inlet thread | Outlet thread | |
|--------|--------------|---------------|-----|
| 515027 | 1/2" 24h | M27 X 1 | 0,1 |

CONICAL IMPACT SOCKET



| Ref. | |
|--------|-----|
| 615004 | 0,1 |

TENSIONER + EXTRACTOR POINT INJECTORS COLLETS



| Ref. | |
|--------|-----|
| 515030 | 0,1 |

UNIVERSAL INJECTOR SEAT CLEANING

H5130



Injector holes cleaning after the extractions is extremely important. This device will allow the technician to perform a perfect job before installing the new injector.

The set includes:

- 2 metal brushes Ø 20mm and 25mm for injector hole cleaning.
- 2 front brushes for injector seat cleaning.
- 1 front brush extension.
- 2 seal plugs to close the injector hole before cleaning.
- 1 seal plug holder to place the sandpapers for cleaning the seat.
- A sanding kit to clean the seat.



| Ref. | |
|-------|-----|
| H5130 | 0,6 |

4 CUTTER SEATS SET

T64901



A set of 4 cutters for cleaning injector seats with centering pilot and T handle.

They are used to clean charcoal deposits from injector seats while changing injectors.

It helps to avoid blow-back problems due to poorly seated injectors

It contains:

- 1 T handle square drive 3/8" length 135 mm.
- 1 injector guide Ø7 mm.
- 1 2,5 mm allen wrench of 2,5mm.
- 1 Flat seat cleaner cutting Ø17 mm and guide Ø17mm for BMW, PSA and Renault.
- 1 Flat seat cleaner cutting Ø17 mm and guide Ø21mm for Mercedes Benz CRD.
- 1 Angular seat cleaner cutting Ø17 mm guide Ø21 mm Fiat and Iveco.
- 1 Flat seat cleaner cutting Ø15 mm and guide Ø17 mm.



| Ref. | Type | |
|--------|-----------|-----|
| T64901 | UNIVERSAL | 1,1 |

UNIVERSAL GLOW PLUG TIPS PULLER

H5120



M8, M9 and M10 glow plug tip remover.

It allows easy removal of broken glow plug tips.

Contains 4 guides with self-centring taps of:

M8x1 - M9x1 - M10x1 - M10x1.25

The length of the tools avoid drilling the cylinder head.

In the event that the tips are stuck in the cylinder head and cannot be removed, we have an ejector that pulls the tip into the cylinder. we have a remover that pulls the tip from the cylinder in case the tips are stuck in the cylinder head and cannot be removed. Magnet available for retrieve it from the injector.

Bullet points

- Guide taps and extractor are perfectly centered to the heater plug.
- The tool length avoids drilling or tapping the cylinder head.
- Slide hammer for tip extraction.



| Ref. | |
|-------|-----|
| H5120 | 1,5 |



VALVE GRINDER

3004



It easily grinds most valves using a bench vice.
30° and 45° angles.
Spare blades available.



Bullet points

- Grinds the valve to the exact angle.
- It is not necessary to grind the valve with a suction cup.

| Ref. | | Spare parts | |
|------|-----|-------------|--|
| | | Cuchilla | |
| 3004 | 1,0 | 258 | |

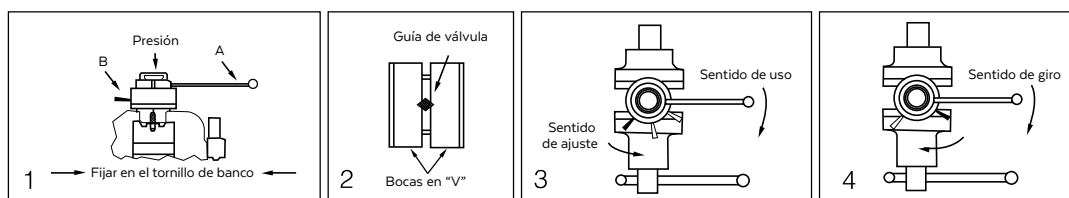

VALVE SEAT CUTTERS

110S



Valve seat milling cutters.
Other cutter sizes on request.



Bullet points

- Hardened steel blades.
- It grinds the main angle and the two complementary ones of each seat.
- The three grinding angles allow the seats to be raised and lowered to the correct width.

| Ref. | Ø | Angles | |
|------|------|--------|-----|
| 110 | 24,8 | 46 | 0,1 |
| 111 | 25,4 | 60 | 0,1 |
| 123 | 24,8 | 31 | 0,1 |
| 128 | 31,8 | 30x46 | 0,1 |
| 203 | 31,5 | 31x46 | 0,1 |
| 212 | 31,6 | 15x75 | 0,1 |
| 213 | 38 | 15x60 | 0,1 |
| 217 | 38 | 15x75 | 0,1 |
| 273 | 31,6 | 15x70 | 0,1 |
| 275 | 38 | 46 | 0,1 |
| 285 | 31,6 | 46 | 0,1 |
| 288 | 50,8 | 15x60 | 0,2 |
| 292 | 44,5 | 15x60 | 0,1 |
| 602 | 31,6 | 31 | 0,1 |
| 622 | 38 | 31x46 | 0,1 |
| 628 | 38 | 31 | 0,1 |
| 642 | 44,5 | 31x46 | 0,1 |
| 652 | 50,8 | 31x46 | 0,2 |



VALVE SEAT CUTTERS KITS

N-70



Equipments for grinding valve seats in cars and trucks.

Bullet points

- Each set contains cutters, guides and accessories for a perfect seat grinding.



| Ref. | Use | Ømin | Ømax | ⚖️ | Spare parts | | |
|-------------|--------|------|------|-----|-------------|---------|-------------|
| | | | | | Guides | Cutters | Accessories |
| N70 | Moto | 18 | 27 | 0,9 | 100-4,5 | 110 | 246 |
| | | | | | 100-5 | | 303 |
| | | | | | 100-5,5 | | 503-1 |
| | | | | | 100-5,52 | | 505 |
| | | | | | 100-6 | | |
| N100 | Coche | 21 | 42 | 0,9 | 150-7 | 275 | 160 |
| | | | | | 150-8 | | 246 |
| | | | | | 150-8,5 | | 505 |
| N300 | Coche | 21. | 42 | 1,3 | 150-7 | 213 | 160 |
| | | | | | 150-8 | | 273 |
| | | | | | 150-8,5 | | 275 |
| | | | | | | | 285 |
| N400 | Coche | 21 | 42. | 1,4 | 150-7 | 203 | 160 |
| | | | | | 150-8 | | 212 |
| | | | | | 150-8,5 | | 217 |
| | | | | | 150-9 | | 622 |
| N500 | Camión | 35 | 55 | 1,8 | 200-10 | 288 | 160 |
| | | | | | 200-11 | | 292 |
| | | | | | 200-12 | | 642 |
| | | | | | 200-9 | | 652 |

PILOT FOR VALVE SEAT CUTTERS

100-40



The guides are inserted into the valve seat to centre the cutter.
The 100 series are fixed-size guides and the rest are expandable guides that perfectly fit in the valve bore.



| Ref. | Ø | Lenght | ⚖️ |
|----------|------|--------|-----|
| 100-4 | 4 | 100 | 0,1 |
| 100-4,5 | 4,5 | 100 | 0,1 |
| 100-5 | 5 | 100 | 0,1 |
| 100-5,5 | 5,5 | 100 | 0,1 |
| 100-5,52 | 5,52 | 100 | 0,1 |
| 100-6 | 6 | 100 | 0,1 |
| 100-6,6 | 6,6 | 100 | 0,1 |
| 100-7 | 7 | 100 | 0,1 |
| 150-6 | 6 | 150 | 0,1 |
| 150-6,5 | 6,5 | 150 | 0,1 |
| 150-7 | 7 | 150 | 0,1 |
| 150-7,5 | 7,5 | 150 | 0,1 |
| 150-8 | 8 | 150 | 0,1 |
| 150-8,5 | 8,5 | 150 | 0,1 |
| 150-9 | 9 | 150 | 0,1 |
| 150-9,5 | 9,5 | 150 | 0,1 |
| 200-10 | 10 | 200 | 0,1 |
| 200-10,5 | 10,5 | 200 | 0,1 |
| 200-11 | 11 | 200 | 0,1 |
| 200-11,5 | 11,5 | 200 | 0,1 |
| 200-12 | 12 | 200 | 0,1 |
| 200-12,5 | 12,5 | 200 | 0,1 |
| 200-8 | 8 | 200 | 0,1 |
| 200-8,5 | 8,5 | 200 | 0,1 |
| 200-9 | 9 | 200 | 0,1 |
| 200-9,5 | 9,5 | 200 | 0,1 |



ACCESORIES & BOXES

505S



All necessary accessories for grinding valve seats.



| Ref. | Description | ⚖️ |
|-------|--|-----|
| 160 | 6 valve box cutters | 0,5 |
| 246 | Hexagonal screwdriver 5/64" + hexagon socket spanner 3/32" + pin + wiper blade | 0,1 |
| 250 | Blade 3/8" | 0,1 |
| 251 | Blade 1/2" from 0 to 46 degrees | 0,1 |
| 253 | Blade 5/16" | 0,1 |
| 254 | Blade 3/4" | 0,1 |
| 258 | HVR carbide blade | 0,1 |
| 303 | 3 cutter box | 0,4 |
| 497 | 11 cutter box | 1,3 |
| 505 | T Wrenche | 0,1 |
| 3003 | Valve seat handle | 0,4 |
| 250LC | Blade 3/8" hard seats | 0,1 |
| 251LC | Blade 1/2" hard seat | 0,1 |
| 503-1 | T motorcycle wrench adapter | 0,1 |

VALVE MOUNTING EXTRACTOR

50210

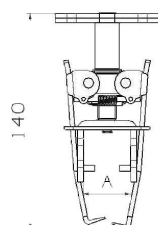

This tool is suitable either for mounting or removing engine valves.

Bullet points

- It allows to keep the spring compressed easily, facilitating the assembly of the two retaining wedges.



| Ref. | spring σ | ⚖️ |
|------|-----------------|-----|
| 5021 | 20-30 | 0,8 |
| 5022 | 30-40 | 0,8 |

VALVE SPRING COMPRESSOR

039500



Valve spring compressor for multivalve engines.

039501 Adapter \varnothing outside 30 \varnothing inside 21

039502 Adapter \varnothing outside 25 \varnothing inside 18

Bullet points

- Large and reinforced steel frame
- Supplied with two adaptors



| Ref. | Max opening | Min opening | Arm length | ⚖️ | AdaptersAdaptador |
|--------|-------------|-------------|------------|-----|----------------------------|
| 039500 | 142 | 35 | 150 | 2,5 | 039501 039502 039505 |



VALVE SPRING COMPRESSOR

660430

Valve spring compressor for cylinder heads with overhead valves. Specific for small engines.



Bullet points

- The open clamping design allows good visibility for hard-to-reach applications.

| Ref. | Max opening | Min opening | Arm length |  |
|---------------|-------------|-------------|------------|---|
| 660430 | 129 | 63 | 158 | 2,0 |

ADAPTORS FOR VALVE COMPRESSORS



| Ref. | External Diameter | Internal diameter |  |
|---------------|-------------------|-------------------|---|
| 039501 | 30 | 21 | 0,1 |
| 039502 | 25 | 18 | 0,1 |
| 039505 | 21 | 15 | 0,1 |

VALVE GRINDERS STICK

660902

Valve grinding stick. Sold in packs of 10.



Bullet points

- Highly effective suction cup, strong adhesion to the valve



| Ref. | Ø | Diameter in dilated state |  | Spare parts |
|----------------|-------|---------------------------|---|-------------|
| | | | | Ventosas |
| 660902C | 32 | 41 | 0,4 | 6609021C |
| 660903C | 22 | 28 | 0,4 | |
| 660904C | 19 | 24 | 0,2 | |
| 660905C | 19/22 | 24/28 | 0,5 | |

TORQUE ANGLE GAUGE

800700

Indispensable tool for tightening bolts to the specified angle by car manufacturers. Indicator: set to 0 before use.



Bullet points

- Anti-reflective and oil-resistant scale surface.



| Ref. | Square |  |
|---------------|--------|--|
| 800700 | 1/2" | 0,4 |
| 800750 | 3/4" | 0,8 |



SILENT-BLOCK PULLERS SET 5193N



Silentblocks puller and other types of bushings and bearings.
 It contains:
 20 tubes diameter from 34 to 72mm
 4 spindles with nuts and bearings: M10, M12, M14 and M16 and 8 different caps.



Bullet points

- The spindle bearings are protected against dirt.
- Suitable for both mounting and dismounting of bushings and silentblocks.



| Ref. | ⚖️ | Spindle | Cup | Shell |
|-------|------|--------------------------------------|--------|-------------------|
| 5193N | 15,8 | 519830 519831 519832 519834 | 519041 | 5190034 - 5190036 |
| | | | 519042 | 5190038 - 5190040 |
| | | | 519043 | 5190042 - 5190044 |
| | | | 519044 | 5190046 - 5190048 |
| | | | 519045 | 5190050 - 5190052 |
| | | | 519046 | 5190054 - 5190056 |
| | | | 519047 | 5190058 - 5190060 |
| | | | 519048 | 5190062 - 5190064 |
| | | | | 5190066 - 5190068 |
| | | | | 5190070 - 5190072 |

SET OF SILENTBLOCK EXTRACTORS WITH SLOTTED TUBES 5198



Silentblocks puller and other types of bushings and bearings.
 It contains:
 20 tubes diameter from 33 to 72mm
 4 spindles with nuts and bearings: M10, M12, M14 and M16 and 8 different caps.



Bullet points

- The spindle bearings are protected against dirt.
- Suitable for both mounting and dismounting of bushings and silentblocks.
- Thanks to the slot, the movement of the silentblock can be observed during removal.



| Ref. | ⚖️ | Spindle | Cup | Shell |
|------|------|--------------------------------------|----------|-------------------|
| 5198 | 15,8 | 519830 519831 519832 519834 | 51983438 | 5198034 - 5198036 |
| | | | 51983640 | 5198038 - 5198040 |
| | | | 51984246 | 5198042 - 5198044 |
| | | | 51984448 | 5198046 - 5198048 |
| | | | 51985054 | 5198050 - 5198052 |
| | | | 51985256 | 5198054 - 5198056 |
| | | | 51985862 | 5198058 - 5198060 |
| | | | 51986064 | 5198062 - 5198064 |
| | | | 51986670 | 5198066 - 5198068 |
| | | | 51986872 | 5198070 - 5198072 |

EXTENDED SILENTBLOCK PULLER SET

5198S



Silentblocks puller and other types of bushings and bearings.

It contains:

21 tubes diameter from 34 to 72mm

4 spindles with nuts and bearings: M10, M12, M14 and M16 and 11 different caps.

It includes 3 pushers of diameter 61,67,5 and 74mm and one M10 screw with adapter



Bullet points

- The spindle bearings are protected against dirt.
- Suitable for both mounting and dismounting of bushings and silentblocks.
- Thanks to the grooving, the movement of the silentblock can be observed during removal.



| Ref. |  | Spindle | Shell | Cup |
|--------------|---|---------|-------------------|----------|
| 5198S | 16,9 | | 5190033 - 5198034 | 51983438 |
| | | | 5198036 - 5198038 | 51983640 |
| | | | 5198040 - 5198042 | 51984246 |
| | | 519830 | 5198044 - 5198046 | 51984448 |
| | | 519831 | 5198048 - 5198050 | 51985054 |
| | | 519832 | 5198052 - 5198054 | 51985256 |
| | | 519834 | 5198056 - 5198058 | 51985862 |
| | | | 5198060 - 5198062 | 51986064 |
| | | | 5198064 - 5198066 | 51986670 |
| | | | 5198068 - 5198070 | 51986872 |
| | | | 5198072 | 51983340 |

VAG FRONT WHEEL HUB REMOVAL SET

5191



Silent-Block pullers set for VAG front wheels, included in the set ref.5198S.

It contains:

complete spindle M12.

Washer Ø25mm.

Adaptors M10 - M12.

Mounting plate Ø74mm.

O-ring pusher Ø61mm.

Screw M10x80.

Cap.

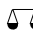

| Ref. |  | Spindle | Cup | Pusher |
|-------------|---|---------|--------|------------------|
| 5191 | 1,9 | 519831 | 519045 | 519057 519056 |



MANUALS FOR THE MOST COMPLEX PRODUCTS



SILENT-BLOCK PUSH PULLERS

5192

Customized push puller designed for working with silentblocks pullers. It can also work as a bolt puller.



Bullet points

- Mechanical spindle that allows hammering to facilitate the extraction.

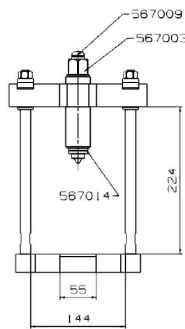

| Ref. | Opening | Height | |
|------|---------|--------|-----|
| 5192 | 144 | 224 | 6,9 |

HYDRAULIC PUSH PULLER FOR SILENTBLOCKS

5192H

Customized designed push puller for silentblocks pullers.



Bullet points

- 8 ton hydraulic spindle.
- The puller's body allows to support the silent-block tubes.

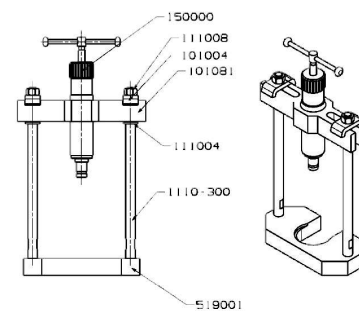
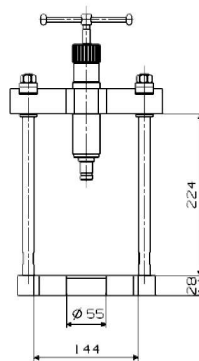
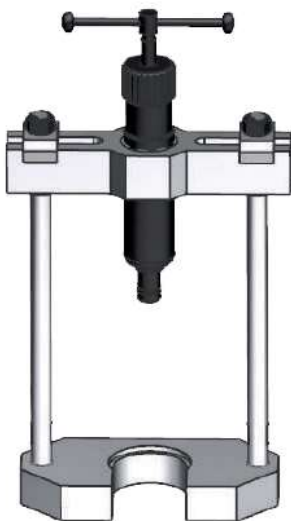

| Ref. | Opening | Height | |
|-------|---------|--------|-----|
| 5192H | 144 | 224 | 6,6 |



EXTENSION FOR SILENT BLOCK PULLER SETS

5195



It allows to increase the capacity of the following sets: 5193N, 5198 and 5198S.

It includes:

5194 push puller, 10 pushers and 8 tubes.

Bullet points

- For silent-blocks or large diameter bushings.
- up to 92mm.
- Very useful when the bushing is placed in difficult access location.



| Ref. |  | Push puller | Shell | Pusher |
|-------------|---|-------------|-------------------|-----------------|
| 5195 | 13,1 | 5194 | 5190033 - 5190074 | 519057 - 519067 |
| | | | 5190076 - 5190078 | 519076 - 519078 |
| | | | 5190080 - 5190082 | 519080 - 519082 |
| | | | 5190084 - 5190086 | 519084 - 519086 |
| | | | | 519088 - 519090 |

PUSH PULLER FOR SILENT BLOCK PULLER 5195

5194



Push puller for silentblocks pullers.

Bullet points

- For silent-blocks or large diameter bushings
- up to 92mm.
- Very useful when the bushing is placed in difficult access location.



| Ref. | Opening | Height |  |
|-------------|---------|--------|---|
| 5194 | 30 | 92 | 0,9 |

COMPLETE SPINDLE

Complete spindles for silentblock.
Includes 2 nuts.



| Ref. | R (Thread) | L (Length) |  |
|---------------|------------|------------|---|
| 519830 | M10 | 340 | 0,5 |
| 519831 | M10 | 340 | 0,6 |
| 519832 | M10 | 340 | 0,7 |
| 519834 | M10 | 340 | 0,9 |

CAPS



| Ref. | Ø | Cup | ⚖ |
|----------|-------|-------|-----|
| 519041 | 72 | A Cup | 0,3 |
| 519042 | 74 | B Cup | 0,3 |
| 519043 | 76 | C Cup | 0,4 |
| 519044 | 78 | D Cup | 0,4 |
| 519045 | 80 | E Cup | 0,4 |
| 519046 | 82 | F Cup | 0,4 |
| 519047 | 70 | G Cup | 0,3 |
| 519048 | 67.6 | H Cup | 0,3 |
| 51983340 | 33-40 | 3340 | 0,1 |
| 51983438 | 34-38 | 3438 | 0,1 |
| 51983640 | 36-40 | 3640 | 0,1 |

| Ref. | Ø | Cup | ⚖ |
|----------|-------|------|-----|
| 51984246 | 42-46 | 4246 | 0,1 |
| 51984448 | 44-48 | 4448 | 0,1 |
| 51985054 | 50-54 | 5054 | 0,2 |
| 51985256 | 52-56 | 5256 | 0,2 |
| 51985862 | 58-62 | 5862 | 0,3 |
| 51986064 | 60-64 | 6064 | 0,3 |
| 51986670 | 66-70 | 6670 | 0,3 |
| 51986872 | 68-72 | 6872 | 0,4 |

TUBES



Silentblock tubes.

| Ref. | External Diameter | Internal diameter | Cups | ⚖ |
|---------|-------------------|-------------------|------|-----|
| 5190033 | 36 | 33 | 9078 | 0,2 |
| 5190034 | 44 | 34 | A-C | 0,3 |
| 5190036 | 46 | 36 | B-D | 0,3 |
| 5190038 | 48 | 38 | C-E | 0,3 |
| 5190040 | 50 | 40 | D-F | 0,3 |
| 5190042 | 52 | 42 | E-H | 0,3 |
| 5190044 | 54 | 44 | F-G | 0,3 |
| 5190046 | 56 | 46 | A-H | 0,3 |
| 5190048 | 58 | 48 | B-G | 0,4 |
| 5190050 | 60 | 50 | A-C | 0,4 |
| 5190052 | 62 | 52 | B-D | 0,4 |
| 5190054 | 64 | 54 | C-E | 0,4 |
| 5190056 | 66 | 56 | D-F | 0,4 |
| 5190058 | 68 | 58 | E-H | 0,4 |
| 5190060 | 70 | 60 | F-G | 0,4 |
| 5190062 | 72 | 62 | A-H | 0,4 |
| 5190064 | 74 | 64 | B-G | 0,5 |
| 5190066 | 76 | 66 | A-C | 0,5 |
| 5190068 | 78 | 68 | B-D | 0,5 |
| 5190070 | 80 | 70 | C-E | 0,5 |
| 5190072 | 82 | 72 | D-F | 0,5 |
| 5190074 | 74 | 84 | 9080 | 0,5 |
| 5190076 | 76 | 86 | 9082 | 0,5 |
| 5190078 | 78 | 88 | 9084 | 0,6 |
| 5190080 | 80 | 90 | 9086 | 0,6 |

| Ref. | External Diameter | Internal diameter | Cups | ⚖ |
|---------|-------------------|-------------------|-----------|-----|
| 5190082 | 82 | 92 | 9088 | 0,6 |
| 5190084 | 84 | 94 | 9090 | 0,6 |
| 5190086 | 86 | 96 | 3640 | 0,6 |
| 5198034 | 34 | 44 | 3438 | 0,3 |
| 5198036 | 36 | 46 | 3640 | 0,3 |
| 5198038 | 38 | 48 | 3438/3640 | 0,3 |
| 5198040 | 40 | 50 | 3640/3340 | 0,3 |
| 5198042 | 42 | 52 | 4246/3438 | 0,3 |
| 5198044 | 44 | 54 | 4448/3640 | 0,3 |
| 5198046 | 46 | 56 | 4246 | 0,4 |
| 5198048 | 48 | 58 | 4448 | 0,4 |
| 5198050 | 50 | 60 | 5054/4246 | 0,4 |
| 5198052 | 52 | 62 | 5256 | 0,4 |
| 5198054 | 54 | 64 | 5054 | 0,4 |
| 5198056 | 56 | 66 | 5256/4448 | 0,4 |
| 5198058 | 58 | 68 | 5862/5054 | 0,4 |
| 5198060 | 60 | 70 | 6064/5256 | 0,4 |
| 5198062 | 62 | 72 | 5862 | 0,5 |
| 5198064 | 64 | 74 | 6064 | 0,5 |
| 5198066 | 66 | 76 | 6670/5862 | 0,5 |
| 5198068 | 68 | 78 | 6872/6064 | 0,5 |
| 5198070 | 70 | 80 | 6670 | 0,5 |
| 5198072 | 72 | 82 | 6872 | 0,5 |

PUSHER

Silentblock pushers.



| Ref. | ∅ | Automotive brand | ⚖️ | Ref. | ∅ | Automotive brand | ⚖️ |
|--------|------|------------------|-----|--------|----|------------------|-----|
| 519056 | 74 | VAG | 0,6 | 519082 | 82 | GENERAL | 0,6 |
| 519057 | 61 | VAG | 0,2 | 519084 | 84 | GENERAL | 0,7 |
| 519067 | 67.5 | BMW | 0,2 | 519086 | 86 | GENERAL | 0,7 |
| 519076 | 76 | GENERAL | 0,6 | 519088 | 88 | GENERAL | 0,8 |
| 519078 | 78 | GENERAL | 0,6 | 519090 | 90 | GENERAL | 0,8 |
| 519080 | 80 | GENERAL | 0,6 | | | | |

UNIVERSAL HUB REMOVAL SET

5180



Specially designed to remove wheel hubs and retract the end of the wheel bearing. It contains 8 sets of adaptors. Supplied with central hydraulic spindle.



Bullet points

- Beam designed for 4, 5, 6 or 7 screws.

| Ref. | Maximum opening | Minimum opening | ⚖️ | Spindle | Male adaptor | Female adaptor |
|------|-----------------|-----------------|------|---------|--|--|
| 5180 | 153mm | 74mm | 10,2 | 101031 | 11103122 11103124 11103142 11103162 11103202 | 11104122 11104124 11104142 11104162 |

UNIVERSAL WHEEL HUB PULLER WITH SLIDE HAMMER

5180C



Specially designed to remove wheel hubs and retract the end of the wheel bearing. It contains 8 sets of adaptors. Supplied with central hydraulic spindle and slide hammer.



Bullet points

- Beam designed for 4, 5, 6 or 7 screws.
- The 5kg slide hammer allows for fast and efficient extraction.



| Ref. | Maximum opening | Minimum opening | ∅min | ∅max | ⚖️ | Slide hammer | Spindle | Male adaptor | Female adaptor |
|-------|-----------------|-----------------|------|------|------|--------------|---------|--|--|
| 5180C | 153mm | 74mm | 74 | 154 | 18,6 | 4396 | 101031 | 11103122 11103124 11103142 11103162 11103202 | 11104122 11104124 11104142 11104162 |

UNIVERSAL HYDRAULIC HUB PULLER SET

5180H



Specially designed to remove wheel hubs and retract the end of the wheel bearing.
It contains 8 sets of adaptors.
Supplied with central hydraulic spindle.



Bullet points

- Beam designed for 4, 5, 6 or 7 screws.
- Hydraulic system: faster extraction with less effort.



| Ref. | Max opening | Min opening |  | Hydraulic spindle | Male adaptor | Female adaptor |
|--------------|-------------|-------------|---|-------------------|--|----------------------------------|
| 5180H | 153 | 88 | 7,5 | 150120 | 11103122 11103124 11103142 11103162 | 11104122 11104124 11104162 |

WHEEL HUB PULLER PLATE TYPE

5460



Specially designed to remove wheel hubs of 4 and 6 screws.
Slide Hammer included.



| Ref. | Ømax | Ømin |  |
|-------------|------|------|---|
| 5460 | 150 | 100 | 3,4 |

MECHANICAL HUB PULLER

51530

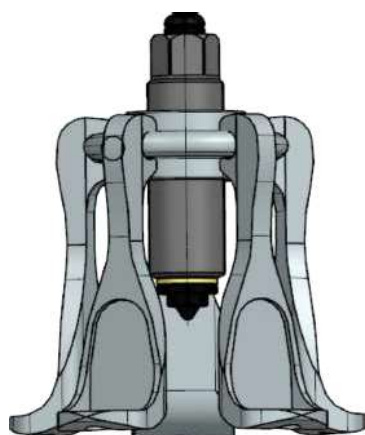

This extractor allows to extract the hubing using the same screws that the hubing itself has to be extracted.
We supply this extractor with 3, 4 or 5 legs.



Bullet points

- The rotation of the legs allows the puller to be placed in different positions to adjust to the hub.
- The reinforced spindle with spindle, extension point and bronze washer allows hammering.

| Ref. | Height | Opening | R (Conection) |  | Spare parts | |
|-------------|--------|---------|---------------|---|-------------|---------|
| | | | | | Jaw | Spindle |
| 5513 | 140 | 250 | 1 1/2" UN 16H | 3,6 | 550305 | 567030 |
| 5514 | 140 | 250 | 2 1/2" UN 16H | 4,1 | 550305 | 567030 |
| 5515 | 140 | 250 | 3 1/2" UN 16H | 4,5 | 550305 | 567030 |

HIDRAULIC HUB PULLER

5113H0

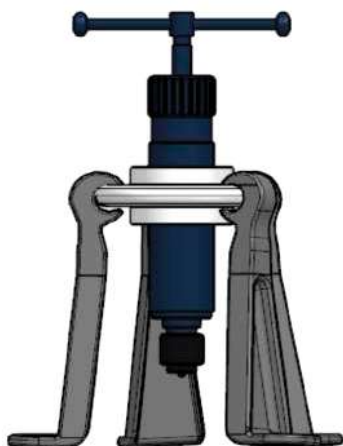

This extractor allows to extract the hubing using the same screws that the hubing itself has to be extracted.
We supply this extractor with 3, 4 or 5 legs.



Bullet points

- The rotation of the legs on its body allows the legs to be positioned in different positions to fit the hubing.
- Hydraulic system: faster extraction less effort.

| Ref. | Height | Opening | R (Conection) | ⚖️ | Spare parts | |
|-------|--------|---------|---------------|-----|-------------------|--------|
| | | | | | Hydraulic spindle | Jaw |
| 5513H | 140 | 250 | 1 1/2" UN 16H | 3,6 | 150000E | 550305 |
| 5514H | 140 | 250 | 2 1/2" UN 16H | 4,1 | 150000E | 550305 |
| 5515H | 140 | 250 | 3 1/2" UN 16H | 4,5 | 150000E | 550305 |

JAW FOR HUB PULLER

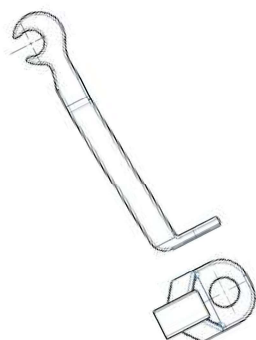

| Ref. | Total jaw length (L) | Jaw width (R) | Thickness | Hole | ⚖️ |
|--------|----------------------|---------------|-----------|------|-----|
| 550305 | 161 | 44 | 6.5 | ø19 | 0,4 |

CV JOINT PULLER

80900

Specially designed puller to remove CV joints on front-wheel drive cars. No need to use a hammer as it reduces the risk of damage to the drive shaft.



Bullet points

- It prevents removing the entire front axle.
- Approved as an official tool by the VW Group.

| Ref. | Type |  |
|--------|-----------|---|
| 080900 | Universal | 2,1 |

DRIVE SQUARE FOR OIL CUP

51820

Square wrenchs specially designed to remove the oil cup.

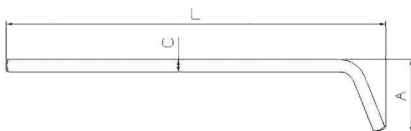

Bullet points

- They do not damage the oil cap of the car.

| Ref. | C | To | L |  |
|------|----|----|-----|---|
| 5182 | 8 | 48 | 221 | 0,1 |
| 5184 | 10 | 50 | 241 | 0,2 |

DOUBLE SQUARE WRENCH FOR OIL CUP

5186

Square wrenchs specially designed to remove the oil cup.

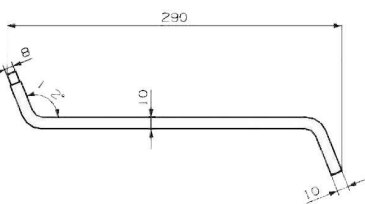
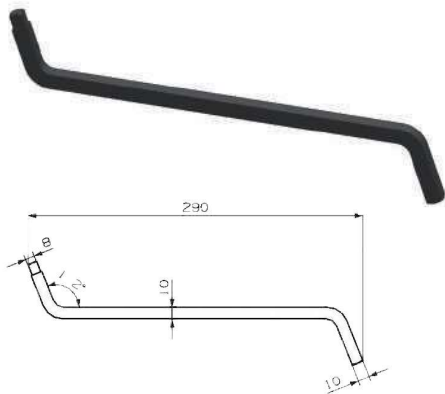

Bullet points

- They do not damage the oil cap of the car.
- 8 and 10mm drive square.

| Ref. | C | To | L |  |
|------|----------|----|-----|---|
| 5186 | 8 and 10 | 50 | 290 | 0,3 |

VACUUM BRAKE BLEEDING KIT

H6010



Complete brake bleeding kit
It contents:
Vacuum gun and brake fluid filling bottles.
Manual nozzle with reservoir
Self-adjusting nozzle with reservoir



Bullet points

- It uses compressed air to generate a deep suction

| Ref. | | Spare parts |
|-------|-----|--------------|
| H6010 | 0,8 | Gun H6011 |

VACUUM GUN AND RESERVOIR

H6011



Vacuum brake bleeding gun and brake refill bottle.



| Ref. | |
|-------|-----|
| H6011 | 0,3 |

BRAKE BLEEDING KIT 1/2L LITRE

H6100



1/2 litre bottle vacuum gun with overflow valve and universal rubber connector.



Bullet points

- It uses compressed air to generate a deep suction and evacuate fluid and air from the hydraulic brake system.
- Hanging hook.

| Ref. | Capacity | Hose dimension | |
|-------|----------|----------------|-----|
| H6100 | 0,5l | 500mm | 1,2 |

MANUAL BRAKE BLEEDER

660500



Manual brake bleeder with non-return valve.
Non return valve ensures that the air does not return back into the system.
Capacity 50cl.



| Ref. | Material | |
|--------|----------|-----|
| 660500 | Plastico | 0,1 |



PNEUMATIC BRAKE CALIPER REWIND TOOL SET

H6320



Set of pneumatic gun and 15 adapters.
For most European and Japanese cars (especially for brakes of the brands Ate, Bendix, Delco...).



Bullet points

- The pushing force is provided by compressed air (from 5 to 8 bar).
- The right-hand or left-hand turn is carried out by the handle

| Ref. | |
|-------|-----|
| H6320 | 3,1 |



BRAKE PISTONS SPREADER

H6305



This tool allows to reposition the brake pistons to facilitate the brake pads replacement.
Specially designed for Ate, Bendix, Delco...



Bullet points

- Specially designed jaws to fit in the space of worn pads on either side of the disc.

| Ref. | Working length | |
|-------|----------------|-----|
| H6305 | 70mm | 0,9 |

MITYVAC VACUUM GAUGE

H1395



Pressure and vacuum tool.
Common applications:
Emission control system testing (EGR, RCV, BPV).
Turbo testing.
Hydraulic clutch bleed and pressure/vacuum brake bleeding
Ignition system diagnostics.
Fluid transfer / evacuation.



Bullet points

- The Kit includes: Metal hand pump MI8510.
- The only hand pump that provides and measures pressure or vacuum with the same performance and accuracy (from 980mBar to +4Bar).
- Large reservoir (480ml) with quick coupler.
- Other accessories.



| Ref. | Pressure | Vacuum | Deposit | |
|-------|----------|--------|---------|-----|
| H1395 | 4 Bar | 1 Bar | 450ml | 2,4 |



COIL SPRING COMPRESOR CENTRAL SPINDLE

5091

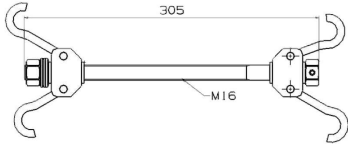

Extractor for vehicle suspensions.
It allows to contract easily the damping springs.

Bullet points

- Suitable for keeping the springs compressed.



| Ref. | Type | Opening | ⚖️ |
|------|--------|---------|-----|
| 5091 | Garras | 305 | 2,5 |

COIL SPRING COMPRESOR DISC TYPE

5092



Extractor for vehicle suspensions.
It allows to contract easily the damping springs.

Bullet points

- Suitable for keeping the springs compressed.



| Ref. | Type | Opening | ⚖️ |
|------|--------|---------|-----|
| 5092 | Discos | 570 | 4,7 |

TWO-ARM SUSPENSION SPRING EXTRACTOR

56400



Vehicle suspension pullers.
2 arm set

Bullet points

- Suitable for keeping springs compressed.
- It can work with the damper mounted.



| Ref. | Opening | ⚖️ |
|------|---------|-----|
| 5640 | 200 | 2,7 |
| 5641 | 300 | 2,9 |
| 5642 | 400 | 3,3 |

LOCKING LOG NUT REMOVAL KIT

H5020



Locking log nut removal kit.
This tool is the definitive solution for removing locknut bolts.
Remove de most difficult locking log nuts.
Valid for all brands
Also removes when the tab screw is damaged.

Bullet points

- Valid for all brands.
- 8,5mm hard metal.
- Professional and fast.



| Ref. | Guides | Puller | Drills | ⚖️ |
|-------|--------------------|--------|--------|-----|
| H5020 | M8-M9-M10-M10x1,25 | 4 | 2 | 2,7 |



WHEEL VALVE KIT

RUD200



Set that includes one valve core remover with tightening torque limiter and wheel valve puller. Supplied in a cardboard box.



Bullet points

- It allows the removal of both the valve and the wheel valve core.
- The tightening torque is limited with audible signal up to 0.4Nm.

| Ref. | | Valve core remover | Valve assemblies |
|--------|-----|--------------------|------------------|
| RUD200 | 0,4 | RUD230 | RUD235 |

VALVE CORE PULLER

RUD230



The tyre vale core remains tighten to the tool thanks to an effective fastening system with a confirmation click. It avoids losing the valve core and allows placing it comfortably.



Bullet points

- Suitable for dismounting the valve core.

| Ref. | |
|--------|-----|
| RUD230 | 0,1 |

WACTH VIDEO



VALVE CORE REMOVER WITH TORQUE

RUD235



The tyre vale core remains tighten to the tool thanks to an effective fastening system with a confirmation click. Adaptable to all types of valves, specially to the electronic TPMS ones, avoiding damaging the valve while tightening the valve core The valve core remains attached to the tool. Standard torque wrench: 0.40 Nw/m also available in (0.25 – 0.40 - 0.45 Nw/m)



Bullet points

- The tightening torque is limited with audible signal up to 0.4Nm.
- Suitable for removing the valve and the wheel valve core.

| Ref. | |
|--------|-----|
| RUD235 | 0,1 |

WACTH VIDEO



WHEEL VALVE PULLER

RUD245



Tyre valve removal tool. Tilting grip jaw made of hardened steel.



Bullet points

- Rubber and nylon support point prevents damage to aluminium rims
- It always gets the right angle for a quick and effortless valve removal
- Compatible with TPMS valves.

| Ref. | |
|--------|-----|
| RUD245 | 0,3 |

WACTH VIDEO



NYLON NAILS

RUD42040

Universal Trimmed nylon head for tyres demounting. Efficient for tyre changers of all types, automatic and swing-armed ones.



Bullet points

- Made of very strong resin
- It does not damage the aluminium rims.



| Ref. | Machine | Material | Finishing | ⚖️ |
|---------|-----------|----------|---------------|-----|
| RUD4204 | Oscillant | Nylon | With slot | 0,2 |
| RUD4205 | Oscillant | Nylon | Large support | 0,2 |
| RUD4206 | All types | Nylon | Short support | 0,3 |

QUICK CONNECTORS

RUD4280

Universal kit to work with the same tyre change using a plastic head for aluminium rims and an iron head for steel rims. It comprises three safety systems.



Bullet points

- With a simple twist we change the iron nail for the nylon one.



| Ref. | Ø | ⚖️ | Spare parts |
|--------|------|-----|--------------|
| | | | Plastic head |
| RUD428 | 28 | 1,7 | RUD4206 |
| RUD429 | 29 | 1,7 | RUD4206 |
| RUD430 | 30 | 1,7 | RUD4206 |
| RUD435 | 35 | 1,7 | RUD4206 |
| RUD499 | Cono | 1,7 | RUD4206 |

WHEEL RIM STICKER CLEANER

RUD590

Tool that easily removes the remaining adhesive from the weights glued the aluminum rims.



Bullet points

- It does not damage the rims.



| Ref. | ⚖️ |
|--------|-----|
| RUD590 | 0,1 |



WATCH VIDEO





TYRE AIR PRESSURE TESTER

32800

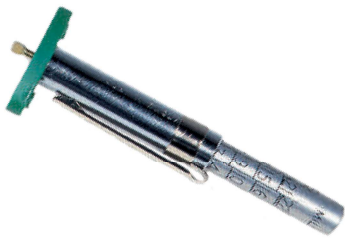

Tool for measuring tire pressure.
Up to 2,5bars.



| Ref. | |
|--------|-----|
| 032800 | 0,1 |

TYRE PRESSURE TESTER



Tool for measuring tire pressure.
With dial indicator.
Units: kg/cm² and lb/sq in.
Pressure measure from 0,5 to 4,5 kg/cm².



| Ref. | |
|--------|-----|
| T61100 | 0,1 |

TYRE BEADING RING

RUD10130



A necessary tool for inflating the tyres when they do not adjust to the rim. It fills the existing space between the rim and the tyre, thus avoiding air from blowing off and allowing, in this way, a fast and safe inflation.

**Bullet points**

- Made of natural rubber and thanks to its elasticity allows to work with various sizes.

| Ref. | Ø | Material | |
|---------|------------|----------|-----|
| RUD1013 | 10 A 13" | Rubber | 1,0 |
| RUD1418 | 14 A 16" | Rubber | 1,2 |
| RUD1921 | 19 A 21" | Rubber | 1,5 |
| RUD2224 | 22,5 A 24" | Rubber | 2,0 |

WACTH VIDEO

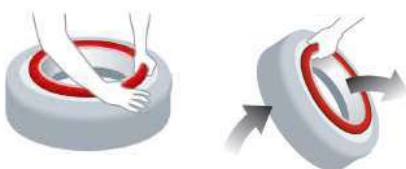

VULCANISED TYRE LEVER

RUD120



Vulcanized tyre lever that improves tire mounting and dismounting.

Bullet points

- It does not scratch aluminium rims.
- It decreases the chance of breaking a beading ring.
- Improved angles to push the tyre more effectively without releasing the tyre.



| Ref. | Lenght | Material | ⚖️ |
|--------|--------|----------|-----|
| RUD120 | 600 | Steel | 0,7 |

WATCH VIDEO



TYRE CHANGER AND REMOVER

RUD350



Auxiliary tool for the assembly and dismantling of tyres. Highly recommended for very low profile and RUN FLAT tyres.

Bullet points

- Steel beam coated with vulcanised rubber to avoid damaging aluminium rims.
- Very suitable for mounting tyres on rims with TPMS valves.



| Ref. | ⚖️ |
|--------|-----|
| RUD350 | 0,4 |

MANUAL IMPACT SPANNER FOR PULLEYS

H6252

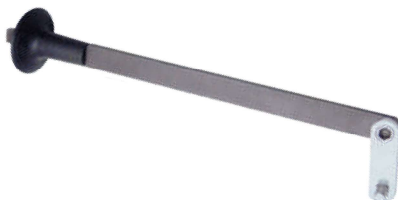

Allows to remove and replace the rocker arms without disassembling the radiator. Used with hammer.

Bullet points

- No compressed air required.



| Ref. | ⚖️ |
|-------|-----|
| H6252 | 2,4 |

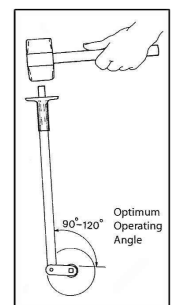
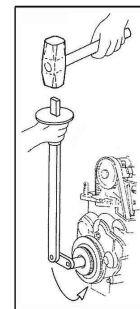



MAGNETIC PLATES EXTRACTOR SET FOR EXTERNAL THREAD 5224IN1000

Magnetic plate extractor with internal thread.



Bullet points

- Spindle end contains a ball to protect the shaft.

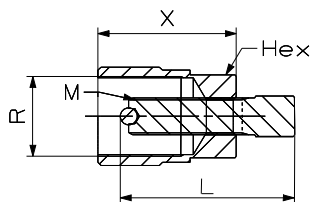

| Ref. | R-Thread | Useful length | ⚖️ |
|-------------|----------|---------------|-----|
| 5224IN100 | M24X100 | 49 | 0,2 |
| 5226IN100 | M26X100 | 45 | 0,2 |
| 5226IN150 | M26X150 | 45 | 0,2 |
| 5230IN100 | M30X100 | 49 | 0,3 |
| 5230IN150 | M30X150 | 48 | 0,3 |
| 5235IN150IZ | M35X150 | 54 | 0,3 |
| 5236IN150 | M36X150 | 54 | 0,4 |
| 5238IN150 | M38X150 | 54 | 0,3 |

MAGNETIC PLATES EXTRACTOR SET FOR INTERNAL THREAD 52160

Magnetic plate extractor with external thread.



Bullet points

- Spindle end contains a ball to protect the shaft.

| Ref. | R-Thread | Useful length | ⚖️ |
|----------|-----------|---------------|-----|
| 5216 | M16X100 | 30 | 0,1 |
| 5219 | M19X100 | 30 | 0,1 |
| 5220 | M20X100 | 30 | 0,1 |
| 5224-1 | M24X100 | 30 | 0,1 |
| 5226 | M26X125 | 30 | 0,1 |
| 5226-1 | M26X100 | 30 | 0,1 |
| 5227 | M27X125 | 30 | 0,1 |
| 5227-1 | M27X100 | 30 | 0,1 |
| 5230 | M30X150 | 30 | 0,2 |
| 5232 | M32X150 | 30 | 0,2 |
| 5233 | M33X150 | 30 | 0,2 |
| 5222-15 | M22X150 | 30 | 0,1 |
| 5223-15 | M23X150 | 30 | 0,1 |
| 5227-1IZ | M27X100IZ | 30 | 0,1 |
| 5228-1 | M28X100 | 30 | 0,2 |
| 5232-1 | M32X125 | 30 | 0,2 |

MAGNETIC PLATES EXTRACTOR SET 5200A

Magnetic plates pullers set with external thread.



Bullet points

- Spindle end contains a ball to protect the shaft.
- It can be used with the most common motorbike models.

| Ref. | Puller | From | ⚖️ | Magnetic plate puller |
|-------|--------|-----------|-----|---|
| 5200A | 8 | M16 a M27 | 0,8 | 5216 5219 5223-15 5224-1 5226 5227 5227-1 5227-1IZ |



BATTERY TERMINAL PLIERS

5050



Battery terminal puller plier type.
Suitable tool for removing battery terminals from passenger vehicles.



| Ref. | |
|------|-----|
| 5050 | 0,5 |

BATTERY TERMINAL PULLER 5400

5400



Battery terminal puller.
Suitable tool for removing battery terminals from larger vehicles.



Bullet points

- Self-centring system: automatic centering of the legs for a better grip.
- It can also be used as a small bearing puller.

| Ref. | Height | Opening | |
|------|--------|---------|-----|
| 5400 | 40 | 50 | 0,2 |

BATTERY TERMINAL PULLER 5401

5401



Battery terminal puller.
Suitable tool suitable for removing battery terminals from heavy vehicles.



Bullet points

- It can also be used as a small bearing puller.

| Ref. | Height | Opening | |
|------|--------|---------|-----|
| 5401 | 40 | 50 | 0,2 |



BATTERY TERMINAL PULLER 5942

5942



Battery terminal puller and small extractions.
Easily remove battery terminal.



Bullet points

- Self-centring system: automatic centering of the legs for a better grip.
- Quick-opening mechanism thanks to the spring.

| Ref. | Opening | Height | |
|------|---------|--------|-----|
| 5942 | 6 - 9 | 28 | 0,4 |

CYLINDER HONING SET

028000



Motorbike cylinder hone.
Tool for honing the brake or clutch cylinder of motorbikes, lawnmowers, outboard engines and small passenger car engines.



Bullet points

- Flexible drive shaft for use with pneumatic or electric drills

| Ref. | Ø | | Spare part |
|--------|----------|-----|------------------|
| | | | Stones |
| 028000 | 13 to 89 | 0,3 | 028001 028002 |

CYLINDER HONING SET FOR CARS

028100



Vehicle cylinder hone.
Tool for larger cylinders such as passenger cars, vans, boats and industrial facilities.



Bullet points

- Flexible drive shaft for use with pneumatic or electric drills.

| Ref. | Diameter max | Diameter min | | Spare part |
|--------|--------------|--------------|-----|----------------------------|
| | | | | Stones |
| 028100 | 180 | 50 | 0,5 | 028101 028102 028103 |



9 SPARE STONES SET

0280010



Replacement stones for cylinder honing 028000:

SET 028001 fine grain 400:
Three stones 20X8mm
Three stones 28x8mm
Three stones 50x8mm

SET 028002 medium grain 220:
Three stones 20X8mm
Three stones 28x8mm
Three stones 50x8mm



| Ref. | Grit | Length | Width |  |
|---------------|--------|----------|-------|---|
| 028001 | Fine | 20-28-50 | 8 | 0,1 |
| 028002 | Medium | 20-28-50 | 8 | 0,1 |

REPLACEMENT STONES SET

0281010



Replacement stones for cylinder honing:

SET 028001 fine grain 400: 101x11mm
SET 028102 medium grain 220: 101x 11mm
SET 028103: coarse grain 100:101x11mm



| Ref. | Grit | Length | Width |  |
|---------------|--------|--------|-------|--|
| 028101 | Fine | 101 | 11 | 0,1 |
| 028102 | Medium | 101 | 11 | 0,1 |
| 028103 | Coarse | 101 | 11 | 0,1 |

STEERING WHEEL PULLER

50820



Puller designed to remove steering wheels.
Model 5082T is equipped with 4 screws.

Bullet points

- Its four slots allow the access up to 4 different holes.



| Ref. | Ømax | Spare parts | |  |
|--------------|------|-------------|----------|---|
| | | Screws | Screws | |
| 5081 | 85 | - | - | 0,4 |
| 5082 | 115 | - | - | 0,9 |
| 5082T | 115 | 3/8" 16h | 3/8" 18h | 1,1 |

EXHAUST PIPE CUTTER

021800



For exhaust tubes from Ø 28 to Ø 68 mm.
Suitable for cutting an exhaust tube without having to disassemble.
Fast and effective.



| Ref. | Ø |  |
|---------------|------------|---|
| 021800 | DE 28 A 68 | 0,9 |



WINDSHIELD WIPER PULLER

57010



Windscreen wiper arm removal tool for vehicles that pull water outside of the wiper arm.

**Bullet points**

- The beam geometry allows to have 4 different puller's spread.

| Ref. | Minimum opening | Maximum opening | Height | | Accessorie |
|------|-----------------|-----------------|--------|-----|------------|
| | | | | | Adaptor |
| 5701 | 17 | 36 | 31 | 0,2 | 570109 |
| 5702 | 24 | 47 | 31 | 0,3 | 570109 |

UNIVERSAL WINDSHIELD WIPER PULLER

5700L



Windscreen wiper arm removal tool for vehicles that pull water outside either or inside of the wiper arm.

**Bullet points**

- The beam geometry allows to have 4 different puller's spread.
- The point protector can be removed for pulling water outside of the wiper arm.

| Ref. | Minimum opening | Maximum opening | Height | | Spare parts |
|-------|-----------------|-----------------|--------|-----|-------------|
| | | | | | Adaptor |
| 5701L | 17 | 36 | 44 | 0,2 | 570109 |
| 5702L | 24 | 47 | 44 | 0,3 | 570109 |

WINDSHIELD WIPER PULLER SET

5700



Suitable for all windshield wiper and small extractions.

Contains:

- 1 external puller 1001.
- 1 puller 5701L
- 1 puller 5702 without spindle and protector.

**Bullet points**

- The beam geometry allows to have 4 different puller's spread.
- The point protector can be removed for pulling water outside of the wiper arm.

| Ref. | | Puller | Windshield wiper puller |
|------|-----|--------|-------------------------|
| 5700 | 1,1 | 1001 | 5702 5701L |

INJECTOR PUMP EXTRACTOR

60120



It is necessary to block the gear that drives the high-pressure fuel pump, when the fuel pump is removed.
Klann equivalence: KL-05850-21.



| Ref. | Thread | Length | |
|-------|---------|--------|-----|
| 60120 | M32x1,5 | 53 | 0,3 |

JUMBO PRY BAR

T51990



Super Grip lever.
Cr-Vn steel.
The head is equipped with a hammering protection.



| Ref. | Length | |
|--------|--------|-----|
| T51990 | 900 | 2,0 |

ALTERNATOR BEARING PULLER KIT

5077C



Complete set to remove alternator bearings.
Supplied with 4 different diameters additional point protectors.

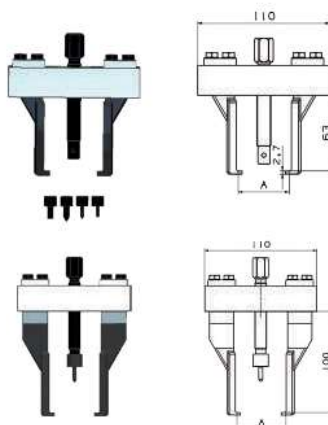

| Ref. | Ømax | Ømin | |
|-------|------|------|-----|
| 5077C | 60mm | 20mm | 1,6 |



GROOVES CLEANER

5040



Specially designed tool for cleaning automotive piston grooves. It includes 2 rotating blades with channel sizes each blade.



| Ref. | |
|------|-----|
| 5040 | 0,4 |

ALTERNATOR BEARING PULLER

5075

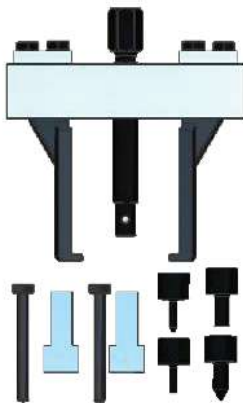

Complete set to remove alternator bearings. Supplied with 4 additional point protectors. Supplied in a cardboard box.



| Ref. | Ømax | Ømin | |
|------|------|------|-----|
| 5075 | 60mm | 20mm | 0,9 |

ALTERNATOR PULLER

5072

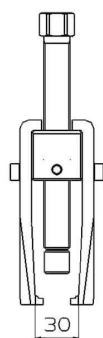

Position 1

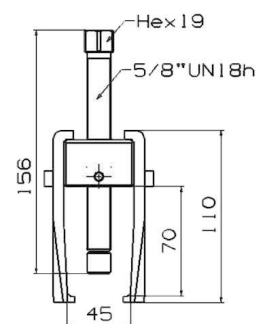

Position 2



| Ref. | |
|------|-----|
| 5072 | 1,1 |

JUMBO PRY BAR SET

T51980

Set of 4 levers to assist in car bodywork repairs.



| Ref. | Lenght |  |
|---------------|-----------------|---|
| T51980 | 200-300-450-600 | 2,1 |

SPOT WELD REMOVAL DRILL

040201

Specially designed drill bit for removal of spot welds on car body repairs.



| Ref. | Ø | Lenght |  |
|---------------|---|--------|---|
| 040201 | 8 | 80 | 0,1 |

METAL SHEET BENDING MACHINE

043100

Specially designed metal sheet bending machine for bending door panels.

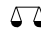

| Ref. | Lenght |  | Spare parts |
|---------------|--------|---|-------------|
| | | | Pad |
| 043100 | 240 | 0,8 | 043102 |

PAD REPLACEMENT FOR METAL SHEET BENDING MACHINE



| Ref. |  |
|---------------|---|
| 043102 | 0,1 |

DOOR TRIM PANEL REMOVAL TOOL

T51940

Lever type puller to release staples from car doors and upholstery.

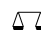

| Ref. | Lenght |  |
|---------------|--------|--|
| T51940 | 240 | 0,2 |



BODYWORK REPAIR DOLLYS

050001



General purpose dollies for body repairs.

- 054801: curved dolly
- 055201: double-ended general purpose dolly.
- 055401: semi circular dolly.
- 055701: double-ended dolly for re-staping rounded.



| Ref. | Purpose | Type | |
|--------|----------|----------------|-----|
| 054801 | Foot | Dactilado fino | 0,9 |
| 055201 | Several | - | 1,2 |
| 055401 | Heel | - | 1,2 |
| 055701 | Rounding | - | 0,7 |

HAMMER FOR BODYWORK

056500



Hammer for chopping with rounded handle end



| Ref. | Head diameter | Lenght | |
|--------|---------------|--------|-----|
| 056500 | 41 | 97 | 0,4 |

BODYWORK FILE

0594000



Bumping tool- flat.
For removing small bumps and dents on corrugated surfaces.
Suitable for semi-finishing work on bodywork.



Bullet points

- The crossed serration prevents the stretching of the metal sheet.

| Ref. | Type | |
|--------|-------|-----|
| 059400 | Plana | 0,8 |

TOOLS SET FOR PULLEYS

H69300



Set of two tools for disassembling and assembling transmission belts.
H6930 Made of nylon reinforced with glass fiber.
H6935 Professional serie Made of aluminium casting.



| Ref. | Material | |
|-------|------------------|-----|
| H6930 | Reinforced nylon | 0,1 |
| H6935 | Aluminium | 0,1 |



TURBO SYSTEM TESTER

H6980



It consists of 4 closing caps and 4 checking caps from 35 to 90 mm. It includes a gauge with integrated regulator for a better leaks reading. It allows the technician to pressurize the whole turbo and inlet system in order to detect quickly and accurately potential leaks.



Bullet points

- Caps with roughened surface for a better grip on the tubes



| Ref. | Ø | ⚖️ |
|-------|---------|-----|
| H6980 | 35 a 90 | 2,6 |

SURGE PROTECTOR

H9010



It protects the vehicle electronics components against voltage peaks when welding or booster starting. Protection against polarity reversal.



Bullet points

- Visual and audible signal.

| Ref. | Volts | ⚖️ |
|-------|---------|-----|
| H9010 | 12 y 24 | 0,5 |

FLOW MASTER COMMON RAIL

H9045



Direct measurement of the return flow of the injector thanks to a graduated and flexible tubes (depending on the flow volume). The set includes 24 adaptors for BOSCH, SIEMENS, DENSO and DELPHI injectors.



Bullet points

- Simultaneous measurement: up to 6 injectors.

| Ref. | Adaptors | ⚖️ |
|-------|----------|-----|
| H9045 | 24 | 1,7 |