



Zástupce pro Českou republiku

FALCON CZECH s.r.o.

Osvoboditelů 2649

440 01 Louny

Telefon: 415 670315

Mobil: 603 50 60 77

info@falconczech.cz

www.falconczech.cz



FORZA®

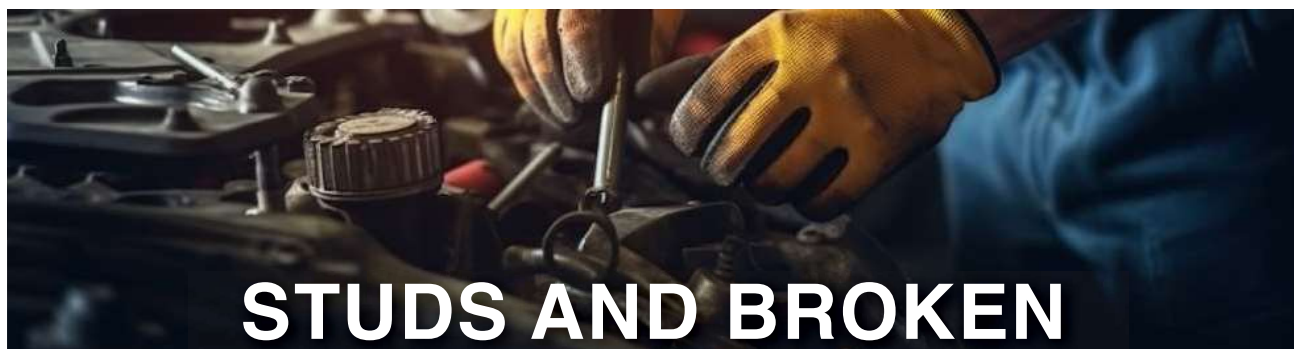

STUDS AND BROKEN SCREWS EXTRACTORS



BROKEN SCREWS AND STUDS EXTRACTOR:

Spanish manufacturing since more than 50 years.

Wide variety of broken stud and screws removal tool set.



BROKEN SCREW AND STUD EXTRACTOR



Stud extractors 135-136



Broken screw extractors 137-140



Helical square extractors sets 141-142



Left hand thread broken stud extractor 143



Broken screw extractor exhibitor 144



Gripping paste and magnetic sockets 144





STUD EXTRACTOR SERIE 2000

2000



Broken stud extractor.
Includes puller body plus two wedge of different sizes in order to block the stud.



Bullet points

- It allows to extract the stud in a very centered position.

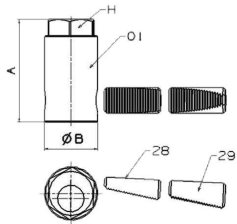

Ref.	Ømax	Ømin	Puller height	Hexagon	Puller external diameter	
2001	16	10	75	30	34	0,4
2002	25	15	100	44	50	1,3

STUD EXTRACTOR SERIE 2100

2100



Extractor for broken studs and screws without head.



Bullet points

- Easy to use.
- It can be used with a wide range of studs.

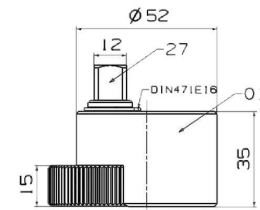

Ref.	Ømax	Ømin	Puller height	Square drive	Eccentric length	
2101	19	6	35	12	15	0,5

STUD EXTRACTOR SERIE 2300

2300



Extractor for broken studs and screws without head.
The body contains an eccentric fixed by a screw.



Bullet points

- The hole is grooved in order to improve the blocking system.
- It allows to extract the stud in a very centered position.

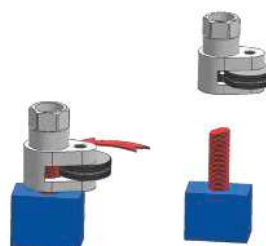

Ref.	Ømax	Ømin	Puller height	
2301	9,5	4,5	46	0,1
2302	19	8	60	0,4
2303	25	15	68	0,6



EXTRACTORS SET WITH ROLLERS

T51310

Set of extractors for extracting studs with rollers. It consists of a body and rollers that apply homogeneous pressure.



Bullet points

- The tool improves the extraction, making the work faster.



Ref.	Threads	⚖️	Spare parts
			Stud extractors
T51310	M6-M8-M10-M12	1,3	T51311 T51312 T51313 T51314

STUD EXTRACTORS

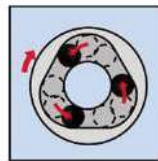
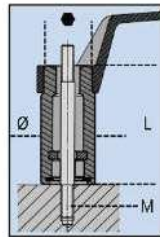

Ref.	Thread	⚖️
T51311	M6	0,2
T51312	M8	0,2
T51313	M10	0,3
T51314	M12	0,3



Discover Bricocrack using our stud and broken bolt extractors!





STUD GROOVED SET SERIE 5010

5010S



Set of 5 broken screws extractors
Contains 5 males and 5 nuts.
Red plastic box.



Bullet points

- Composed of straight grooved males which prevent the screw thread expansion while being nailed.
- Left threaded screws can be also extracted.

Ref.	From	To	⚖️	Spare parts
				Stud grooved extractors
5010	M-5	M20	0,3	5011 - 5012 - 5013 5014 - 5015
5010E	M-5	M20	0,3	5011 - 5012 - 5013 5014 - 5015

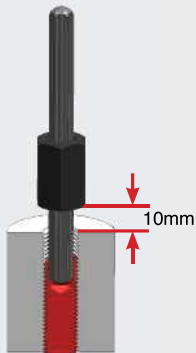

For a proper extractors work, is important:

- 1- Use the largest extractors.
 - 2- Work with the nut 10mm away.
- If the distance is too short, the screw uses to break.
If the distance is too long, the screw easily twits.
The males because of its little value can consider consumables.



Drill the broken screw with the diameter which corresponds.
The extractor is introduced with a hammer.
With a wrench turn the inverse way to the screw.



STUD GROOVED EXTRACTORS



Ref.	Lenght	Drill diameter	Hexagon nut	Nut height	⚖️
5011	57	4	10	16	0,1
5012	68	5	11	16	0,1
5013	78	6	13	16	0,1
5014	84	7.5	14	16	0,1
5015	94	8.5	16	16	0,1





DRILLS AND EXTERNAL GUIDES SET SERIE 5010C

5010C

Set of 5 broken screws puller.
Contains 5 males, 5 nuts, 5 drill bits and 10 external guides.
Red plastic box.



Bullet points

- Composed of straight grooved males which prevents the screw thread expansion while being nailed.
- Left threaded screws can be also extracted.

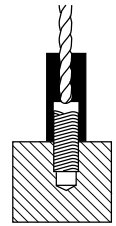

Exterior

Ref.	From	To	⚖️	Spare parts		
				Stud grooved extractors	Right hand drill	Guides set
5010C	M-5	M20	0,7	5011	501040	5010CK1 5010CK2 5010CK3
				5012	501050	
				5013	501060	
				5014	501075	
				5015	501085	

RIGHT DRILL BITS

Drills for screw extractors.



Ref.	Drill diameter	⚖️
501040	4	0,1
501050	5	0,1
501060	6	0,1
501075	7,5	0,1
501085	8,5	0,1

EXTERNAL GUIDES SETS

Guides for screw extractors.



Ref.	Screw exterior	∅ Drill	Nº of guides	⚖️
5010CK1	M-5, M-6, ∅7, M-8	4	4	0,1
5010CK2	M-8, ∅9, M-10	5	3	0,1
5010CK3	∅11, M-12, M-14	6 - 7,5 - 8,5	3	0,1



DRILLS AND DOUBLE GUIDES SET SERIE 5010CD 5010CD



Set of 5 broken screw extractors.
Contains 5 males, 5 nuts, 5 drill bits and 10 external and internal guides.
Red plastic box.



Bullet points

- Composed of straight grooved males which prevents the screw thread expansion while being nailed.
- Left threaded screws can be also extracted.

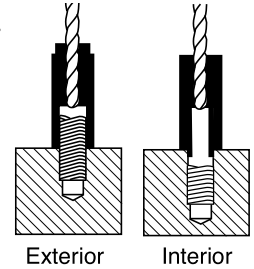

Ref.	From	To	⚖️	Spare parts		
				Stud grooved extractors	Right hand drill	Set guides
5010CD	M-5	M20	0,7	5011	501040	5010CDK1
				5012	501050	
				5013	501060	
				5014	501075	
				5015	501085	
						5010CDK3

EXTERNAL AND INTERNAL GUIDES SETS

External and internal dual guide for screw extractors.



Ref.	External	Internal	ø Drill	Nº of guides	⚖️
5010CDK1	M-5, M-6, ø7, M-8	-, M6, M8, 3/8"	4	4	0,1
5010CDK2	M-8, ø9, M-10	1/2", M-10, 7/16"	5	3	0,1
5010CDK3	ø11, M-12, M-14	M12, M14, M16	6 - 7,5 - 8,5	3	0,1



LEFT HAND DRILLS AND INTERNAL & EXTERNAL GUIDES SET

5010KI



Set of 5 broken screws extractors.
Contains 5 males, 5 nuts, 5 drill bits and 10 external and internal guides.
The drills should rotate counterclockwise (left).
Red plastic box.



Bullet points

- Composed of straight grooved males which prevents the screw thread expansion while being nailed.
- Left hand drills loosening the screw during drilling.
- Left threaded screws can be also extracted.



Ref.	From	To	⚖️	Spare parts		
				Stud grooved extractors	Drills	Set guides
5010KI	M-5	M20	0,7	5011	501140	5010CDK1 5010CDK2 5010CDK3
				5012	501150	
				5013	501160	
				5014	501175	
				5015	501185	

LEFT DRILL BITS



Ref.	Drill diameter	⚖️
501140	4	0,1
501150	5	0,1
501160	6	0,1
501175	7,5	0,1
501185	8,5	0,1

STUD AND SCREW EXTRACTORS SET SERIE 9001

9001



Set of broken screw extractors.
Contains 5 males, 5 nuts, 5 drill bits, 10 external and internal guides and 2 extractor for broken studs ref. 2301&2302.
Red plastic box.



Bullet points

- Composed of straight grooved males which prevents the screw thread expansion while being nailed.
- It also contains broken stud extractors.
- Left threaded screws can be also extracted.



Ref.	⚖️	Spare parts		
		Stud extractor	Set	Right hand drill
9001	1,1	2301 2302	5010CD	501040 - 501050 501060 - 501075 501085



HELICAL SQUARE EXTRACTORS SET SERIE 5010N

5010N

Set of 4 broken screws extractors.
Supplied in a red plastic suitcase.



Bullet points

- Left hand helical square extractors for easy removal of the extractor from the screw.

Ref.	From	To	⚖	Spare parts
				Helical extractors
5010N	M-6	M-16	0,4	5011N 5012N 5013N 5014N

HELICAL SQUARE EXTRACTORS SET SERIE 5010NS

5010NS

Set of 6 broken screws extractors.
Supplied in a blue plastic suitcase.



Bullet points

- Left hand helical square extractors for easy removal of the extractor from the screw.

Ref.	From	To	⚖	Spare parts
				Helical extractors
5010NS	M-6	M-26	1,0	5011N - 5012N 5013N - 5014N 5015N - 5016N

HELICAL EXTRACTORS

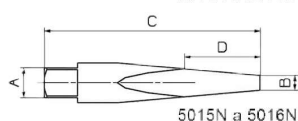
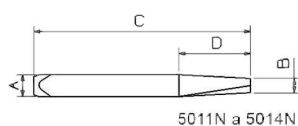

Ref.	Square	Square	Length	Pyramid length	ø Drill	Screw	⚖
5011N	6	3	102	26	3,75 a 4	From M6 to M8	0,1
5012N	8	4	108	35	4,7 a 5	From M8 to M10	0,2
5013N	10	5.5	118	37	6,5 a 7	From M10 to M12	0,3
5014N	12	7.8	118	39	10 a 10,5	From M14 to M16	0,1
5015N	18	8	130	45	12 a 15	From M16 to M22	0,3
5016N	18	12.7	130	47	13 a 16	From M20 to M26	0,3
5017N	22	13	145	50	16	From M24 to M34	0,6



DRILLS AND EXTERNAL GUIDES SET SERIE 5010TR

5010TR



Set of 4 broken screws puller.
Contains 4 drill bits and 8 external guides
Red plastic box.

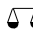

Ref.	From	To		Spare parts	
				Right hand drill	Helical extractors
5010TR	M-6	M-16	0,7	501040	5011N - 5012N
				501050	5013N - 5014N



- 1- Use the most largest possible extractor.
- 2- Make the hole as biger as possible, this weakened the screw when extracting and makes the extractor.
- 3- Since it is square, the whole handle can be pulled with the wrench as low as possible, this makes the extractor twist less.

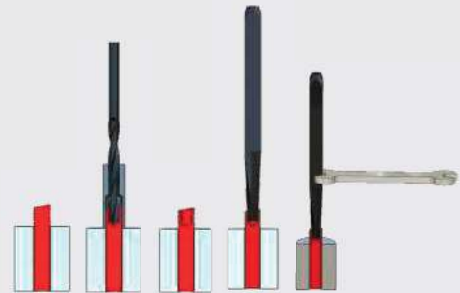

BROKEN SCREW EXTRACTOR IN BOX SERIE 5010RE

5010RE



Set of 5 broken screw extractors with left-hand tapered thread
Supplied in a red plastic box.



Bullet points

- Thanks to the left hand conical thread, while pulling right hand the extraction is easilier

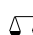
Ref.	From	To		Spare parts	
				Left thread extractors	
5010RE	M-5	M-20	0,2	5011R - 5012R	5013R - 5014R
				5013R - 5014R	5015R
				5015R	

LEFT HAND THREAD EXTRACTORS



Ref.	Smaller diameter	Bigger diameter	Square	Lenght	Drill	
5011R	2.7	4	5	51	3	0,1
5012R	3.3	4.7	5	58	4	0,1
5013R	4.6	6	6	66	5	0,1
5014R	5.5	8	8	73	6	0,1
5015R	6.7	10.5	10	80	8	0,1



5 SCREW EXTRACTOR SET 5-19MM **5135**

Square stud extractor set.
Drill bits from 3 mm to 9.5mm.



Bullet points

- Left threaded screws can be also extracted.

Ref.	Ømin	Ømax	⚖️	Spare parts
				Square stud extractor
5135	M5	M18	0,2	51351 - 51352 - 51353 51354 - 51355

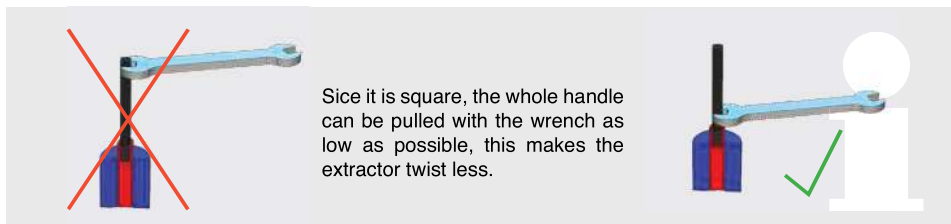

Since it is square, the whole handle can be pulled with the wrench as low as possible, this makes the extractor twist less.

SQUARE STUD EXTRACTORS



Ref.	Drill	⚖️
51351	3mm(1/8")	0,1
51352	4.5mm(3/16")	0,1
51353	6mm(15/16")	0,1
51354	7.5mm(5/16")	0,1
51355	9.5mm(3/8")	0,1

5 LEFT-HAND THREADED SCREW EXTRACTORS **T51300**

Economical set of 5 left-hand thread extractors for broken screws.



Ref.	From	To	⚖️
T51300	4	20	0,1



BROKEN SCREWS EXTRACTORS EXHIBITOR 50100

50100



Strong cardboard display consisting of 2 models of screw extractors:
 -Left-hand tapered thread 5010RE broken screw extractor.
 - Serie 5010E stud grooved set.



Bullet points

- Improves the presence of the product at the sales point.

Ref.	Contains		Exhibitor
50100	3 - 5010E + 6 - 5010RE	2,0	50100E

SREW GRAB

GG005



Gripping paste which helps the tools not to slip.
 Very useful for allen wrenches, screwdrivers... Help to loose and ti
 tight damaged screws.



Ref.	
GG005	0,1

Screw Grab Video



MAGNETICS SOCKETS

5200420



Removable magnetic socket wrench inserts securely holds nuts,
 bolts, self-tapping screws inside the socket to reach hard-to-reach
 areas.



Suitable for 1/4", 3/8" and 1/2" socket spaners.

Bullet points

- Avoid loosing screws while working.



Ref.	Measures	
5200420	Inch: 3/8" - 7/16" - 1/2" - 9/16" - 5/8" - 11/16" - 3/4" - 13/16" - 7/8"	0,1
5210420	Milimeters: 10 - 11 - 12 - 13 - 14 - 15 - 16 - 17 - 18 - 19	0,1